

## MEMORIAL & MOUNTAIN VIEW NEW SCHOOL CONSOLIDATION INFORMATION NIGHT

April 5, 2018

6:00 p.m.

Memorial SC Elementary School

The Hamilton-Wentworth District School Board acknowledges our presence on ancestral Anishinaabe and Haudenosaunee Confederacy land as determined by the Dish with One Spoon treaty.

The intent of this agreement is for all nations sharing this territory to do so responsibly, respectfully and sustainably in perpetuity.

We respect the longstanding relationships with the local Indigenous communities, the Mississaugas of the New Credit First Nation and the Six Nations of the Grand River.



Jeff Gillies	Superintendent of Student Achievement
Nadeen Shehaiber	Manager Capital Projects
Maureen O'Shaughnessy	Principal Architect
Keri Beevor	Architect
Tanya Shaver	Executive Assistant
Sue Dunn	Principal – Memorial SC
Darrin Griffiths	Principal – Mountain View
Jeff Beattie	Trustee – Wards 9 & 10

- Lower Stoney Creek School Consolidation Overview
- Plans for New School on Memorial SC Site
- Memorial-Mountain View Transition Process
- Timelines / Next Steps

On June 6, 2016, Trustees approved the following with respect to the Lower Stoney Creek Pupil Accommodation Review:

*That Collegiate Avenue, Eastdale, Green Acres, Memorial (SC), Mountain View and R.L. Hyslop be closed pending Ministry of Education funding for three new JK-8 elementary schools on the Collegiate, Eastdale and Memorial (SC) sites.*

On June 19, 2017 the Ministry announced funding for a **new JK-8 elementary school for 495 students to be built on the existing Memorial SC site.**

**Memorial SC** students remain at the current Memorial School during construction of the new school and move when construction is complete. Following opening of the new school, the existing Memorial School will be closed and demolished.

**Mountain View (Zone 4)** students move from Mountain View to the new school on the grounds of the current Memorial site when construction is complete.

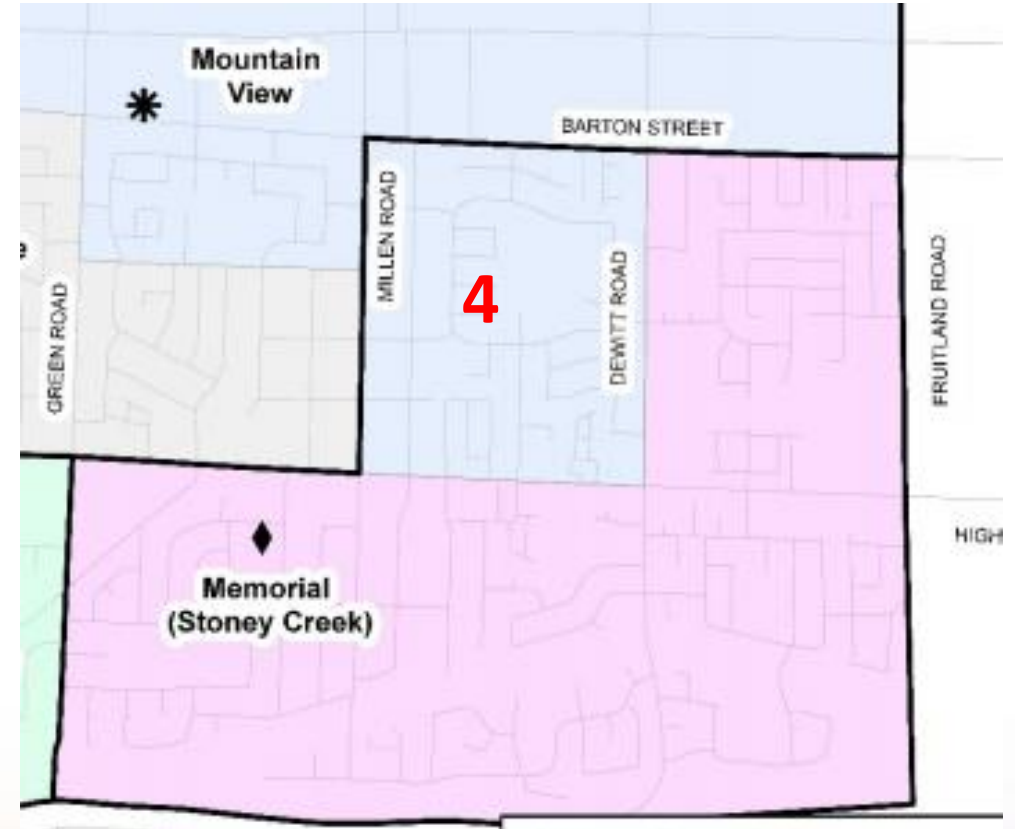

	Capacity	2020 Capacity	2017	2018	2019	2020	2021	2022	2023	2024	2025
Memorial (SC)	358	495	380	378	368	565	542	535	524	516	515
Utilization			106%	106%	103%	114%	109%	108%	106%	104%	104%





# HWDSB

## NEW SCHOOL ON MEMORIAL SITE



curiosity

creativity

possibility



- \$12,039,902 funding provided for 495 pupil place JK-8 school
- Built on Memorial grounds (Royce & Kilbourn)

# HWDSB NEW SCHOOL

- Three room Child Care Facility with secured play area
- Four Kindergarten rooms with secured play area
- Eighteen Classrooms (including science, art, music and special education)
- Community Gathering Spaces



curiosity

creativity

possibility



# HWDSB

## NEW SCHOOL ON MEMORIAL SITE

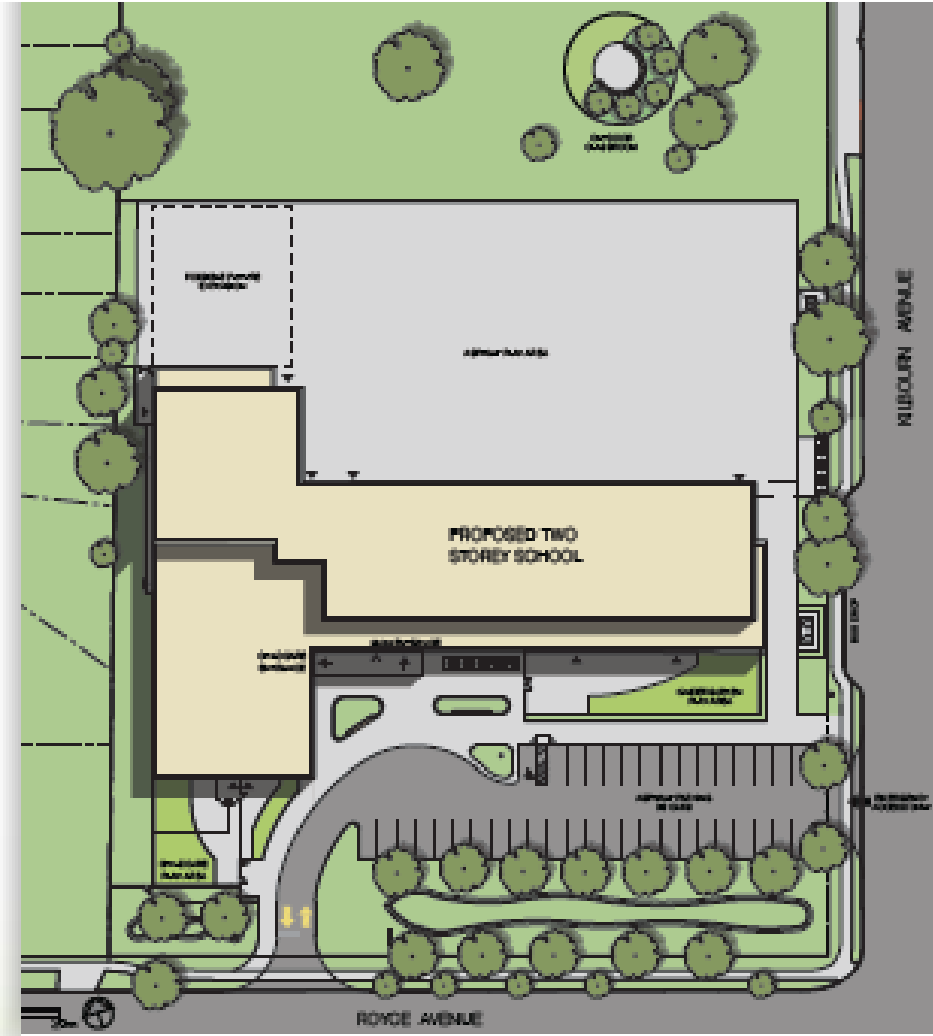

curiosity

creativity

possibility

- 4 Kindergarten Rooms with access to secured outdoor play area
- Connected classes to promote team teaching and improved supervision





- 5500 square foot double gym
- Resilient sports flooring
- Gym divider curtain to accommodate two or more classes
- Scoreboard
- Fixed Stage



- Large open space
- Natural light
- Flexible seating/learning areas



- Area (sf): 1000
- Teaching wall with white board and interactive short throw projector
- Teacher coat & book storage cabinet
- Lockable full height cupboards with open adjustable shelving for instrument storage
- Large stainless steel sink for cleaning instruments and separate small sink for mouth piece sanitization



Adelaide Hoodless Music Room



- Area (sf): 1050
- Teaching wall with white board and interactive short throw projector
- Teacher coat & book storage cabinet
- Counter with two large sinks and cabinets below and above
- Deep cabinets for storage of paper and art supplies



Adelaide Hoodless Art Room

- Area (sf): 1050
- Teaching wall with white board and interactive short throw projector
- Teacher coat & book storage cabinet
- Teacher demonstration station located centrally in room with sink
- Counter with two large sinks and cabinets below and above



### *Overview of Project Phases:*

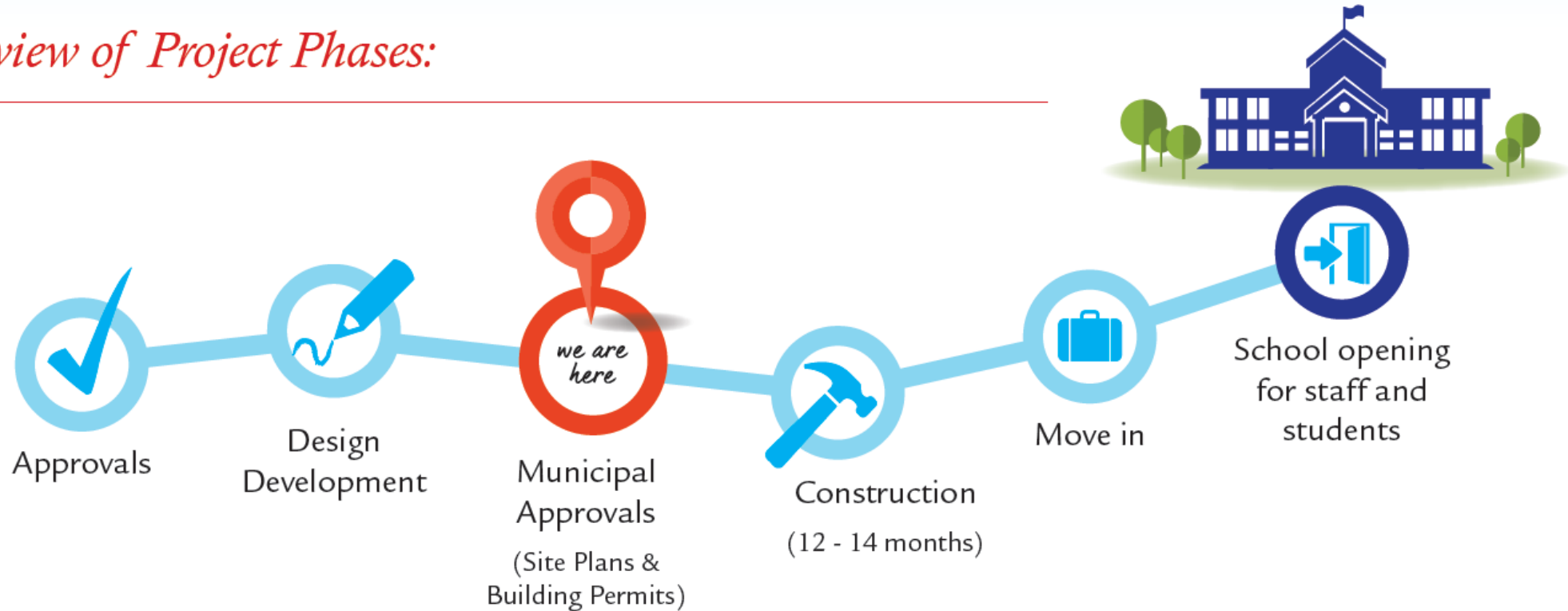

- Project is currently in Municipal Approvals Phase
- School construction takes 12 – 18 months following Approvals Phase

If the Board of Trustees' decision is consolidation, closure or major program relocation, the following school year will be used to plan for and implement the Board's decision.

A separate advisory group (Transition Committee) will be established to address the transition for students and staff of the affected schools.

Pupil Accommodation Review Procedure for Policy # 2.5

Transition Committees meet several times and provide advice to the Superintendent on a variety of matters including:

- Artefacts and/or traditions to be incorporated into the new school
- School naming based on Naming of Schools Policy # 2.3
- Activities to support students and families prior to actual move
- Opening/closing ceremonies

### Ongoing Communication

- Regular Updates - letters, website, school newsletters, etc.
- School Council Updates
- Community Meetings
- Transition Committee Meetings
- Signage





curiosity

creativity

possibility

On behalf of our planning team, thank you for participating and engaging in this important work. For additional information or questions contact your school Principal or:

Jeff Gillies

HWDSB - Superintendent of Student Achievement

[tshaver@hwdsb.on.ca](mailto:tshaver@hwdsb.on.ca)

905-527-5092 ex. 2361

Jeff Beattie

HWDSB - Trustee Wards 9 & 10

[jsbeatti@hwdsb.on.ca](mailto:jsbeatti@hwdsb.on.ca)

289-339-9666