

## EASTDALE & MOUNTAIN VIEW COMMUNITY INFORMATION NIGHT

November 29, 2017

6:00 p.m.

Eastdale Elementary School

Jeff Gillies	Superintendent of Student Achievement
Jeff Beattie	Vice-Chair & Area Trustee
Darrin Griffiths	Principal
Lindsay Snell	Vice-Principal
Amie Myszkowski	Project Supervisor
Ellen Warling	Manager of Planning & Accommodation
Tanya Shaver	Executive Assistant
Priscilla Ladouceur	Principal Architect
Brandon Martin	Program Architect

- Lower Stoney Creek Accommodation Review Resolution
- Ministry of Education Funding Overview
- Plans for New School on Eastdale Site
- Relocation to Mountain View School
- Eastdale-Mountain View Transition Committee
- Timelines / Next Steps

On June 6, 2016, Trustees approved the following with respect to the Lower Stoney Creek accommodation review:

1. That Collegiate Avenue, Eastdale, Green Acres, Memorial (SC), Mountain View and R.L. Hyslop be closed
2. pending Ministry of Education funding for three new JK-8 elementary schools on the Collegiate, Eastdale and Memorial (SC) sites

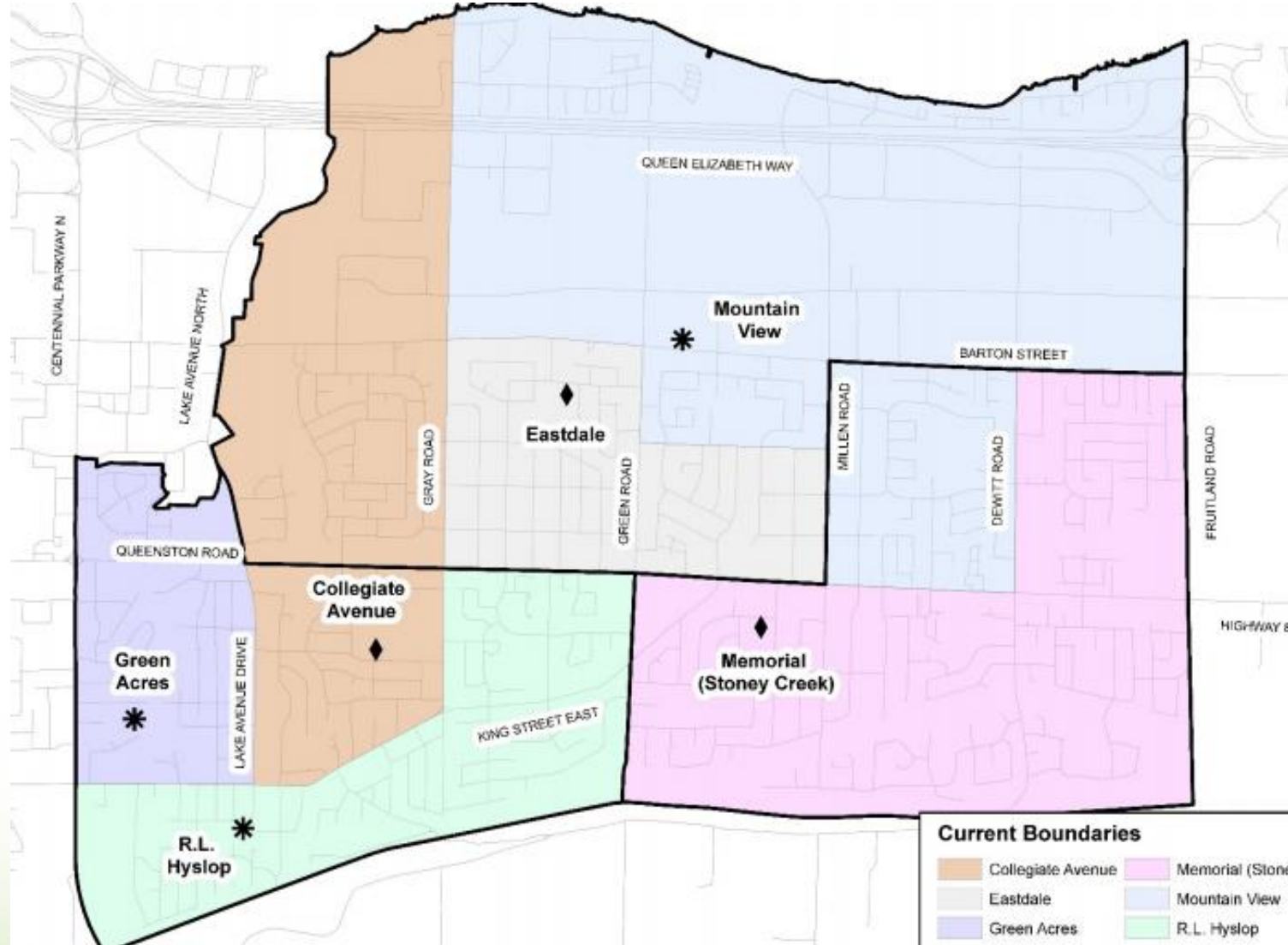

On October 28, 2016 the Ministry of Education announced funding for building of a **new JK-8 elementary school for 564 students to be built on the existing Eastdale site.**

On June 19, 2017 the Ministry announced funding for a **new JK-8 elementary school for 495 students to be built on the existing Memorial SC site.**

On June 19, 2017 the Ministry announced funding for **an addition to Collegiate Elementary School to accommodate 213 students.**





- \$11,557,854 funding provided for 564 pupil place K-8 school
- Rebuilt on current Eastdale site

Architect rendering of New Elementary School from Main Entrance

# HWDSB

- New Bus Lay-By Lane on Lincoln Road
- Outdoor Classroom
- Secured Kindergarten Area
- Connection to Park to Remain
- Community Gathering Spaces
- Retain Old Growth Trees
- Student Vegetable Garden

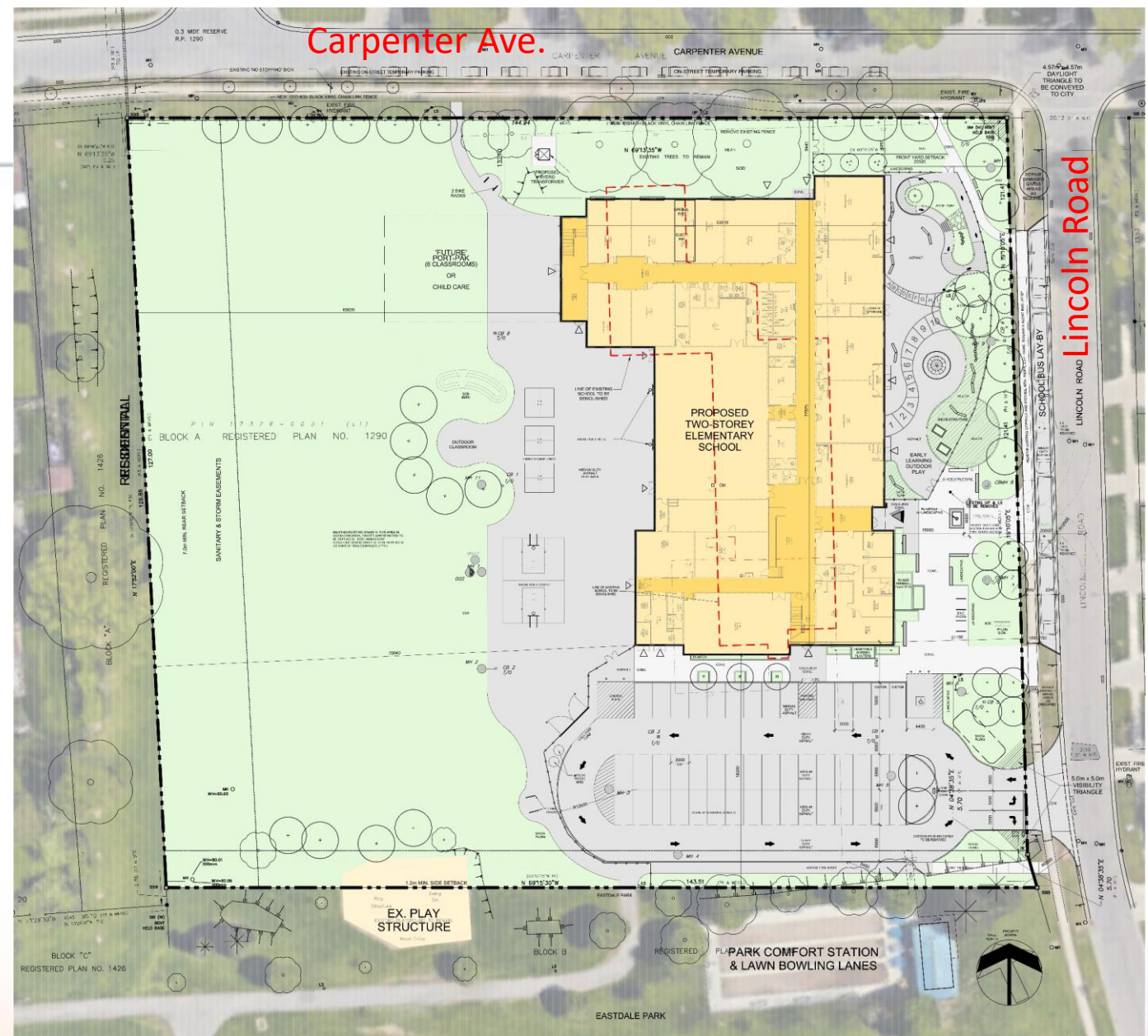

curiosity

creativity

possibility



## New School Gym

- Double Gym with Natural Light
- Fixed Stage with Electric Folding Partition
- Large Gym Storage Room
- Direct Connection to General Purpose Room & Music Room (through Stage)

Architect Rendering of Gymnasium

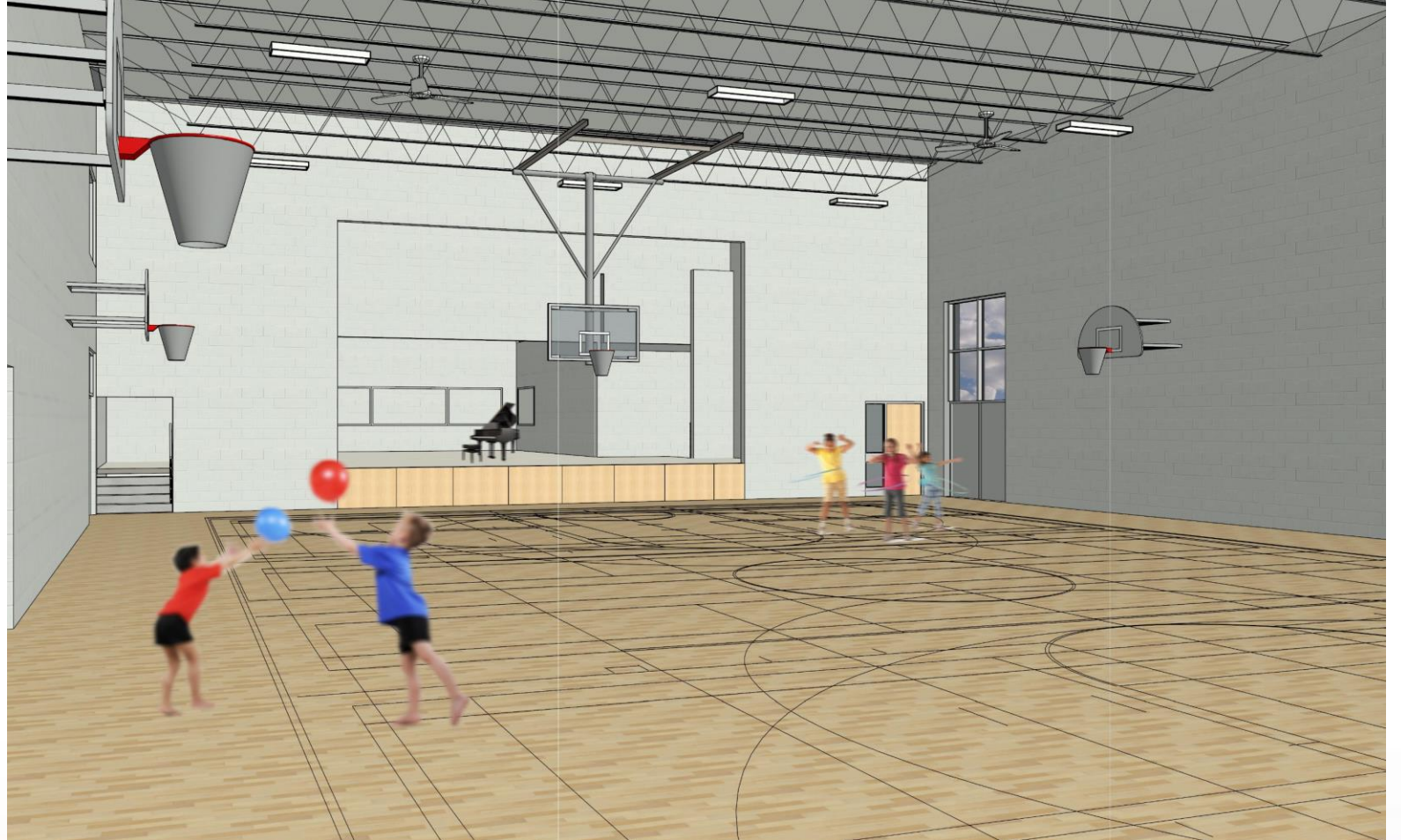

## New School Music Room

- Clerestorey Windows for Direct & Indirect Natural Light
- Direct Connection to Gymnasium & Stage for Flexibility
- Raised Music Room – Level with Stage
- Motorized Folding Partition
- Instrument Storage Cabinets



Architect Rendering of Music Room



## New School Learning Commons

- Learning Commons
- Large and open common space with natural light
- Views to the Park

Architect Rendering of New School Learning Commons





## Full Day Kindergarten:

- 5 Kindergarten Rooms
- Enclosed outdoor play space
- Permanent shade structures
- Outdoor Storage Room (no bunkers)

New Elementary School  
FDK 'Slice' Perspective

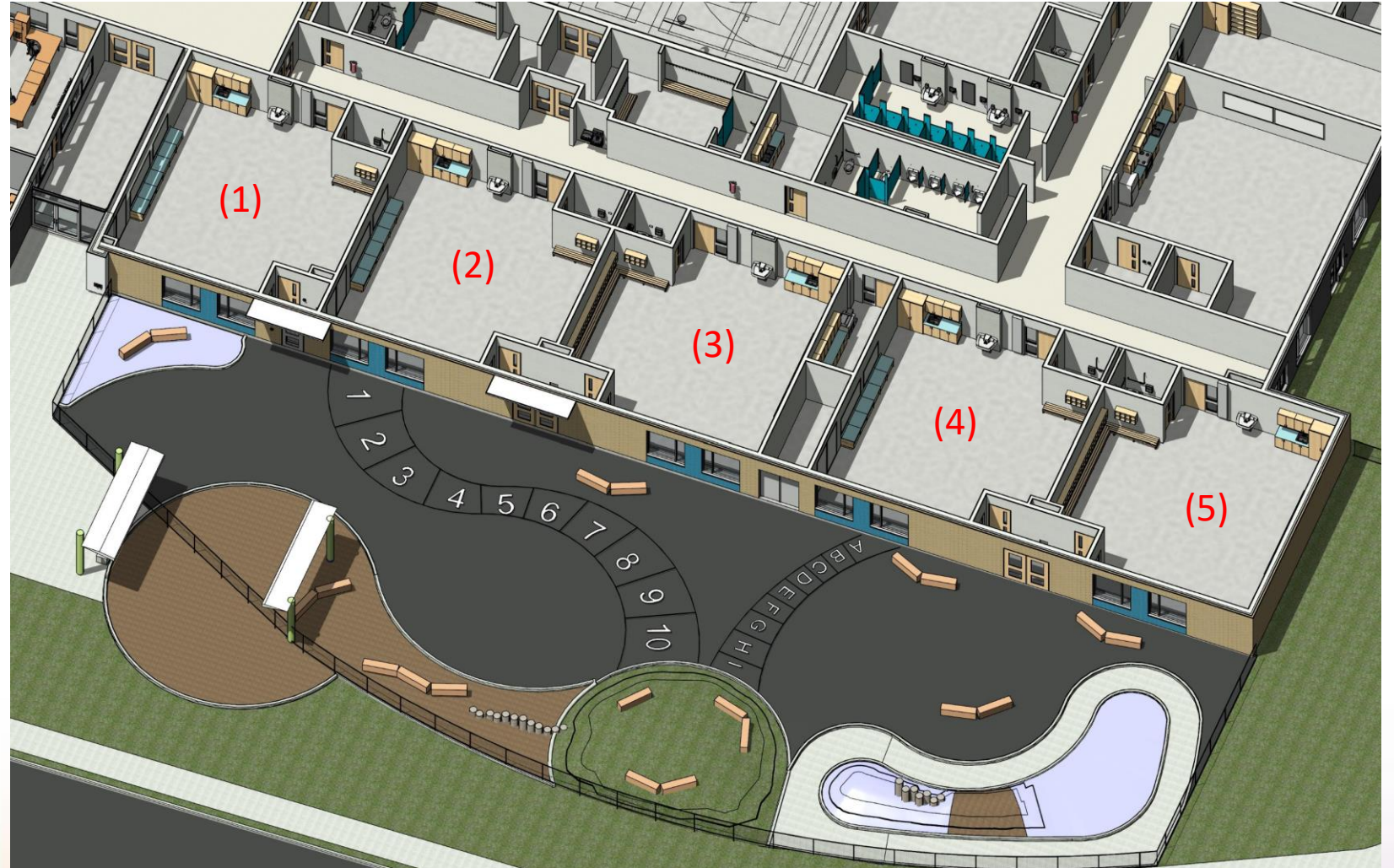



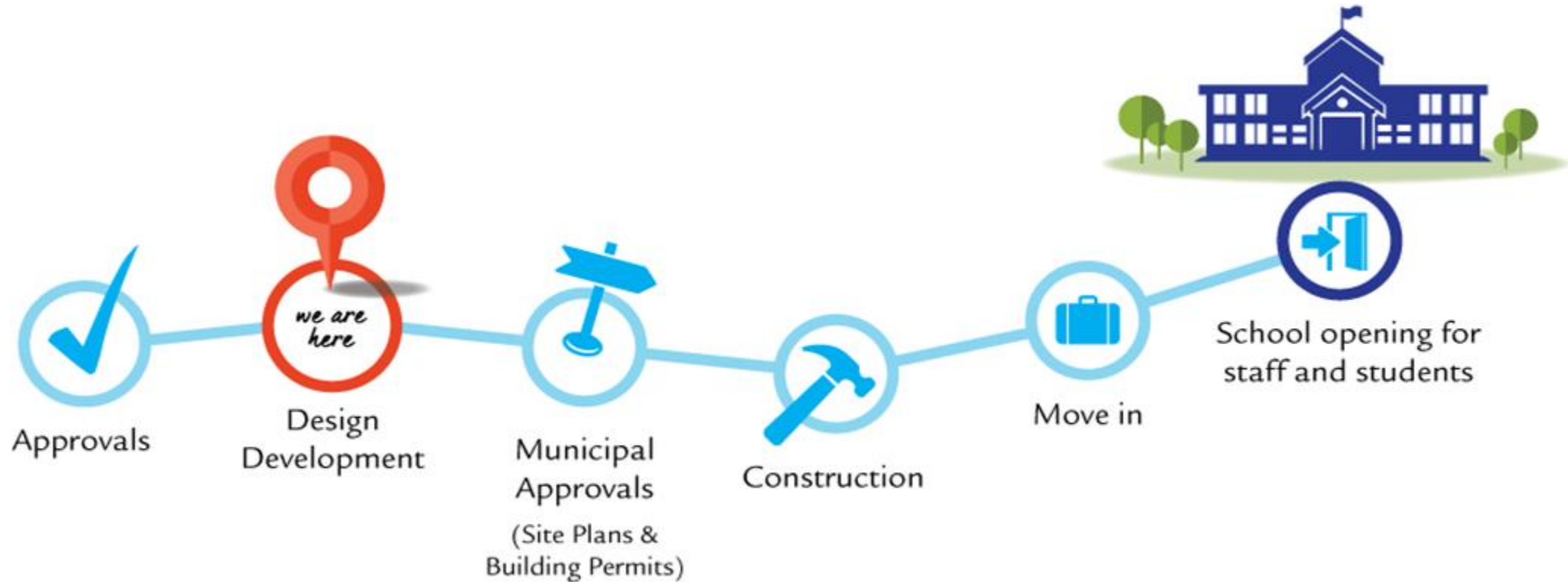

- Project is currently in Municipal Approvals Phase
- Projected completion for 2019/2020 school year (12 – 18 months).

# HWDSB RELOCATION TO MOUNTAIN VIEW

---

Eastdale students will be accommodated at Mountain View school commencing September 2018.

## Rationale:

- Proximity – Relocating to Mountain View keeps Eastdale students within own community
- Eastdale community stays together through relocation and transition
- Eastdale & Mountain View can form new school community together prior to moving to new school

curiosity

creativity

possibility

- Mountain View will be configured to service additional portable classrooms to accommodate incoming students
- Universal barrier free washroom
- Accessible Main Entrance with new concrete sidewalk from parking area
- New ramp to ensure accessibility to playground
- Currently reviewing feasibility to expand parking lot





Portable  
Washroom Access

Accessible  
Washroom

8 Portable Classrooms with  
asphalt walkway

Accessible  
Play Area

Accessible  
Entrance

Expanded  
Gravel Parking &  
Bus Turn Around

Revised Fencing  
to suit new Bus  
Loop

Concrete  
sidewalk from  
Parking/ Street



Bussing will be available to eligible students as per HWDSB Transportation Policy

- Students in kindergarten who reside more than 1 Km from Mountain View will be eligible for transportation
- Students in grades 1 to 8 who reside more than 1.6 Km from Mountain View will be eligible for transportation

HWDSB will continue to collaborate with City of Hamilton staff to ensure crossing guards at key locations to ensure safe walking to and from school.



If the Board of Trustees' decision is consolidation, closure or major program relocation, the following school year will be used to plan for and implement the Board's decision.

A separate advisory group (Transition Committee) will be established to address the transition for students and staff of the affected schools.

Pupil Accommodation Review Procedure for Policy # 2.5

Phase 1 Transition to Mountain View

Phase 2 Transition to the new school at Eastdale



- The Transition Committee provides advice to support a smooth and successful transition for all students, staff and families.
- Transition Committees are led by the Superintendent of Student Achievement in partnership with the school Principal and Vice-Principal.
- Transition Committees typically have a series of meetings prior to the commencement of the planned transition.

Transition Committees provide advice on a variety of matters including:

- Artefacts and/or traditions to be incorporated into the new school
- School renaming based on Naming of Schools Policy # 2.3
- Activities to support students and families prior to actual move
- Opening/closing ceremonies

Transition Committees are typically composed of the following representatives from each affected school:

- Principal & Vice-Principal
- 1 Student
- 1 Teacher, 1 Learning Resource Teacher & 1 Support Staff Member
- 1 School Council Member & 1 Home & School Association Member
- 1 Parent Representative
- 1 Community Partner
- 1 Special Education Advisory Council Member (SEAC)
- Area Trustee

Event	Projected Date
Transition Committee Formation	Nov. 29 – Dec. 12
Transition Committee Meeting #1 (Mountain View)	Dec. 13 @ 6:00 p.m.
Transition Committee Meeting #2 (Eastdale)	Jan. 31 @ 6:00 p.m.
Transition Committee Meeting #3 (Mountain View)	Apr. 4 @ 6:00 p.m.
Closure of Eastdale	June 29, 2018
Accommodation Upgrades at Mountain View	Summer 2018
Demolition & construction of new school at Eastdale	Starting Summer 2018 (12-18 months)



THANK YOU