

EASTDALE & MOUNTAIN VIEW TRANSITION COMMITTEE MEETING #1

December 13, 2017

6:00 p.m.

Mountain View School

Students

Riley Highfield, Banni Thind

Parents

Baljinder Dhoophur, Laura McKeown

School Council Parent Reps.

Justine Brown, Sasha Walsh

Teachers

Summer Fraser, Hillary White

Learning Resource Teachers

Ryan Crawford, Jennifer Glaves

Administrators

Darrin Griffiths & Lindsay Snell

Executive Assistant

Tanya Shaver (tshaver@hwdsb.on.ca)

Ward Trustee

Jeff Beattie

Superintendent

Jeff Gillies

- Norms for Meeting & Collaborating
- Transition Planning
- Transition Committees
- Overview of Accommodation Review & Plans
- Transition Committee Topics for Discussion

HWDSB NORMS FOR MEETING & COLLABORATING

As a group committed to supporting a smooth transition from Eastdale to Mountain View we commit to:

- Treating all individuals with respect
- Listening when someone is speaking
- Being open to different ideas/perspectives/opinions
- _____
- _____
- _____

curiosity

creativity

possibility

If the Board of Trustees' decision is consolidation, closure or major program relocation, the following school year will be used to plan for and implement the Board's decision.

A separate advisory group (Transition Committee) will be established to address the transition for students and staff of the affected schools.

Pupil Accommodation Review Procedure for Policy # 2.5

Transition #1 Closing Eastdale & Temporary Holding Site
2017-18

Transition #2 Moving to New School at Eastdale Site
2018-19 (Collegiate, Eastdale & Mountain View)

Transition #3 Moving to New School at Memorial
2019-20 (Mountain View & Memorial)

- The Transition Committee provides advice to support a smooth and successful transition for all students, staff and families.
- Transition Committees are led by the Superintendent of Student Achievement in partnership with the school Principal and Vice-Principal.
- Transition Committees typically have a series of meetings prior to the commencement of the planned transition.

Transition Committees provide advice on a variety of matters including:

- Artefacts and/or traditions to be incorporated into the new school
- School renaming based on Naming of Schools Policy # 2.3
- Activities to support students and families prior to actual move
- Opening/closing ceremonies

Event	Projected Date
Transition Committee Meeting #1 (Mountain View)	Dec. 13 @ 6:00 p.m.
Transition Committee Meeting #2 (Eastdale)	Jan. 31 @ 6:00 p.m.
Transition Committee Meeting #3 (Mountain View)	Apr. 4 @ 6:00 p.m.
Closure of Eastdale	June 29, 2018
Accommodation Upgrades at Mountain View	Summer 2018
Demolition & Construction of New School at Eastdale	Starting Summer 2018 (12-18 months)

The Board of Trustees approved the closure of Collegiate Avenue, Eastdale, Green Acres, Memorial (SC), Mountain View and R.L. Hyslop Schools and the opening of three new JK-8 elementary schools on the Collegiate, Eastdale and Memorial (SC) sites with modified boundaries between these three schools.

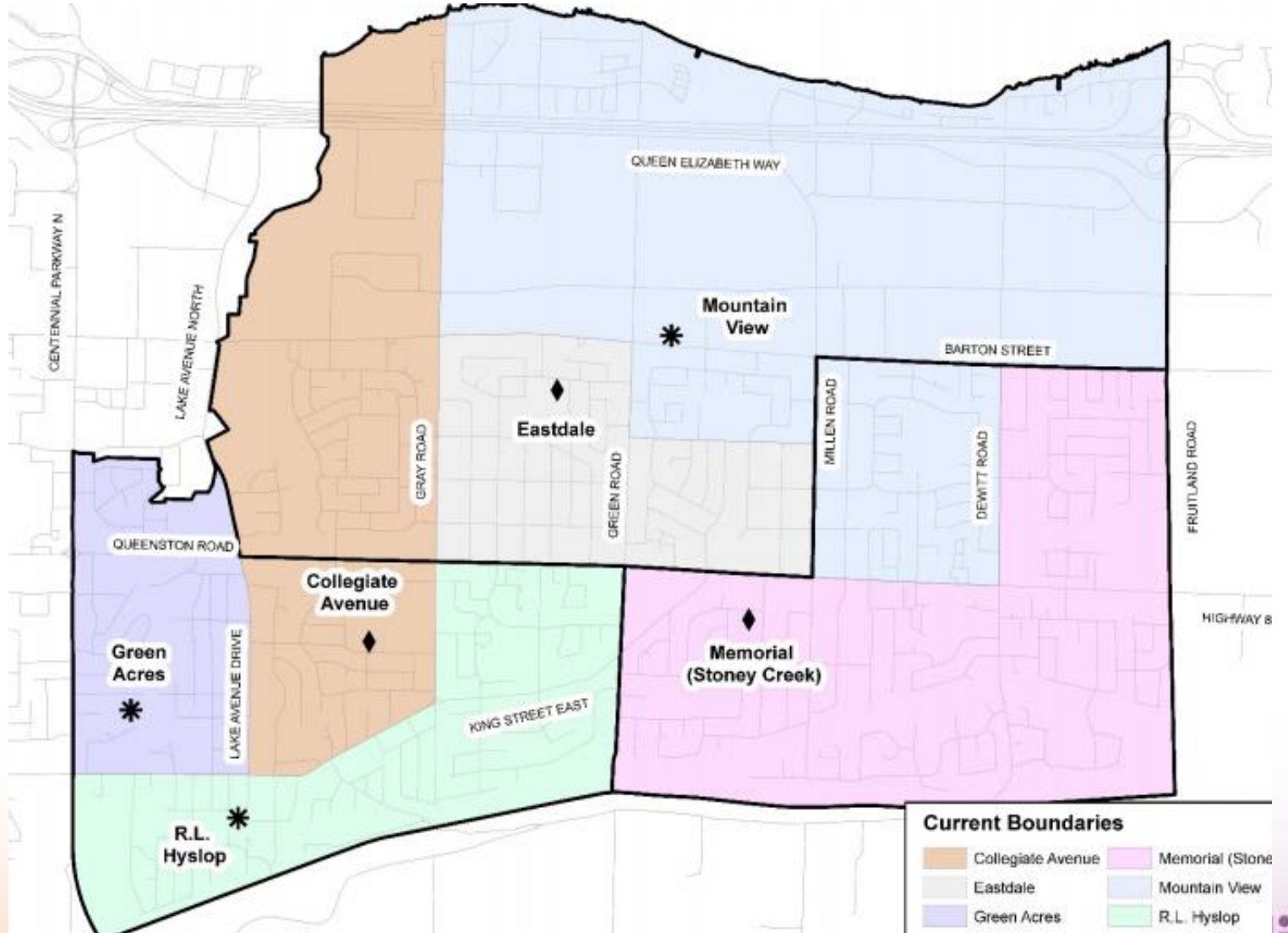

On October 28, 2016 the Ministry of Education announced funding for building of a **new JK-8 elementary school for 564 students to be built on the existing Eastdale site.**

On June 19, 2017 the Ministry announced funding for a **new JK-8 elementary school for 495 students to be built on the existing Memorial SC site.**

On June 19, 2017 the Ministry announced funding for **an addition to Collegiate Elementary School to accommodate 213 students.**

HWDSB

NEW SCHOOL ON EASTDALE SITE



curiosity

creativity

possibility

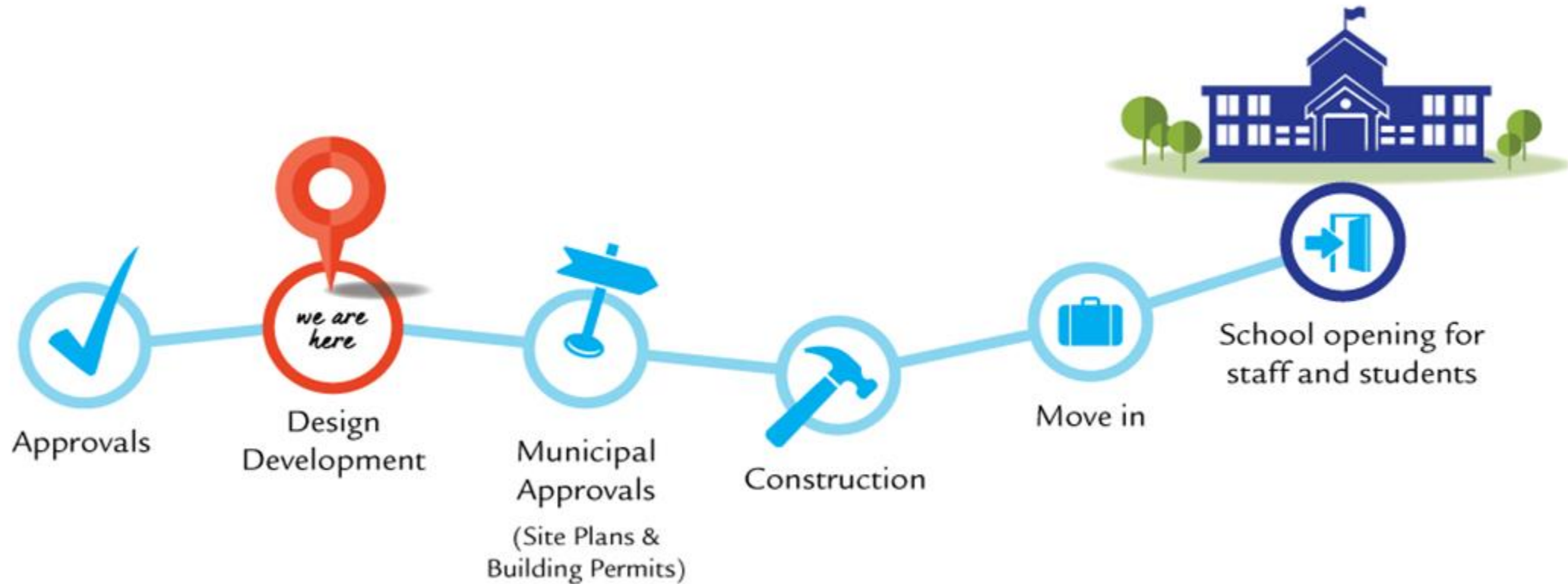

- Project is currently in Municipal Approvals Phase
- Projected completion for 2019/2020 school year (12 – 18 months).

HWDSB RELOCATION TO MOUNTAIN VIEW

Eastdale students will be accommodated at Mountain View school commencing September 2018.

Rationale:

- Proximity – Relocating to Mountain View keeps Eastdale students within own community
- Eastdale community stays together through relocation and transition
- Eastdale & Mountain View can form new school community together prior to moving to new school

curiosity

creativity

possibility

- Mountain View will be configured to service additional portable classrooms to accommodate incoming students
- Universal barrier free washroom
- Accessible Main Entrance with new concrete sidewalk from parking area
- New ramp to ensure accessibility to playground
- Currently reviewing feasibility to expand parking lot

HWDSB

UPGRADES AT MOUNTAIN VIEW

- Expanded Parking with Bus Loop
- Accessible Parking, Walkways, Entrances & Washroom
- Portable Classrooms

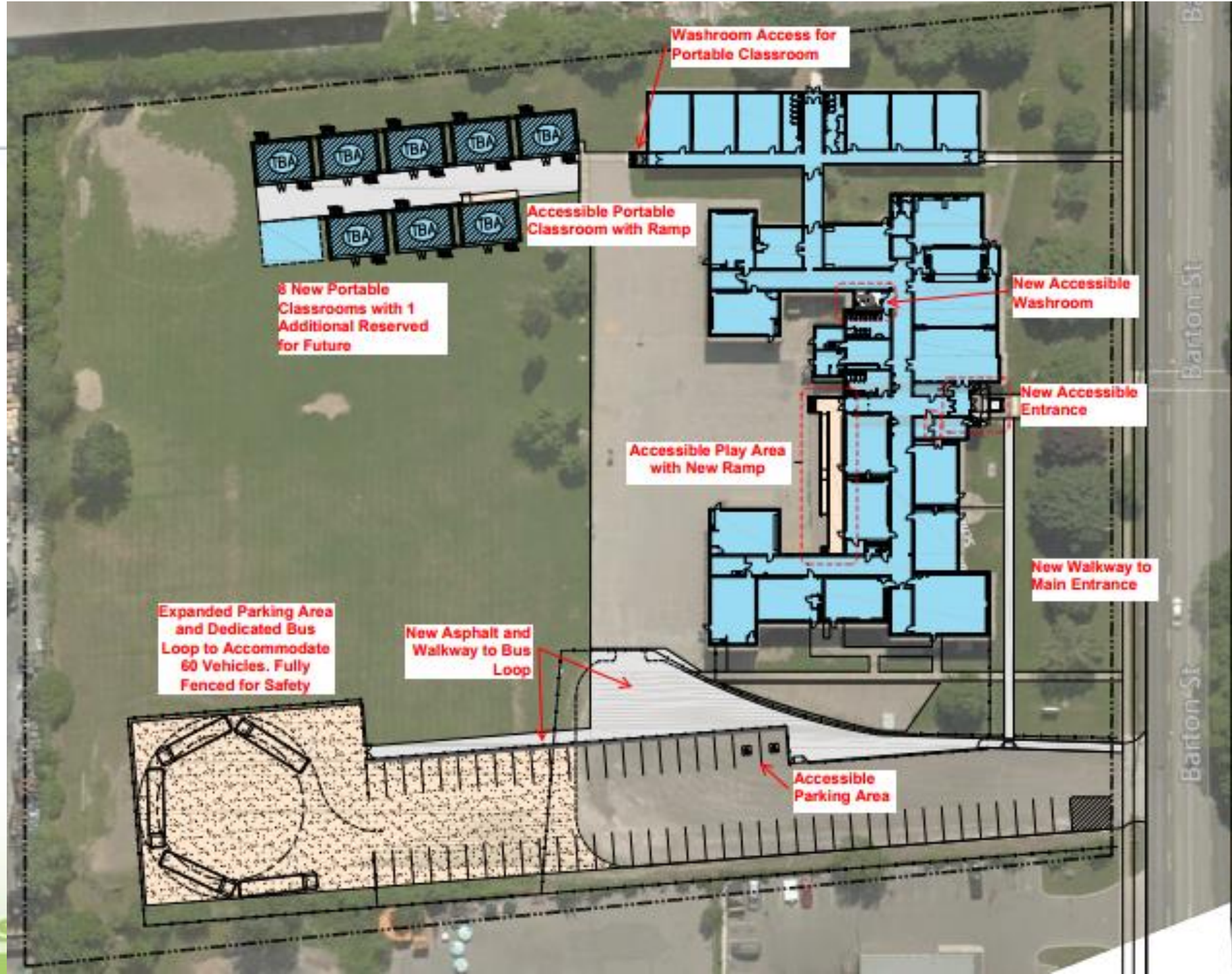

HWDSB ENROLMENT / CAPACITY – 2018-19

JK	SK	1	2	3	4	5	6	7	8	TOTAL	AVAIL.
58	60	54	38	60	47	58	64	61	50	549	553

curiosity

creativity

possibility

Washrooms Required / Available

Students

Girls 11 / 18

Boys 10 / 19

Staff

3 / 4



Bussing will be available to eligible students as per HWDSB Transportation Policy

- Students in kindergarten who reside more than 1 Km from Mountain View will be eligible for transportation
- Students in grades 1 to 8 who reside more than 1.6 Km from Mountain View will be eligible for transportation

HWDSB will continue to collaborate with City of Hamilton staff to ensure crossing guards at key locations to ensure safe walking to and from school.



As we prepare for the transition from Eastdale to Mountain View, what are some important items for discussion/planning?

Example:

- Planning Shared School Activities During 2017-18 School Year
- Communication – Keeping families informed
- Student Life - Extracurricular Activities, Excursions, Special Events, etc.

Event	Projected Date
Transition Committee Meeting #2 (Eastdale)	Jan. 31 @ 6:00 p.m.
Transition Committee Meeting #3 (Mountain View)	Apr. 4 @ 6:00 p.m.
Closure of Eastdale	June 29, 2018
Accommodation Upgrades at Mountain View	Summer 2018
Demolition & Construction of New School at Eastdale	Starting Summer 2018 (12-18 months)

THANK YOU