



**West Hamilton Accommodation City Review
Working Group Meeting #7
Wednesday March 22, 2017
6:00 pm**

**Dr Davey
99 Ferguson Avenue North,
Hamilton, Ontario**

Agenda

- | | |
|-------------------------------------------------------------------------------------------------------------------------------------------------------------------------------------------------------------------------------------------------------------------------------------|----------|
| 1. Housekeeping Items | 20 mins |
| <ul style="list-style-type: none">• Minutes from WG#5, #6, PM#2• Correspondence• Additional meetings• Advisory Committee mandate | |
| 2. Public Meeting #2 Debrief | 60 mins |
| <ul style="list-style-type: none">• Data gathered | |
| 3. Roundtable Discussion – individual committee member thoughts. | 60 mins |
| 4. Interim Final Report | Deferred |
| <ul style="list-style-type: none">• Contents of the report• How does the committee envision capturing the work they've completed?<ul style="list-style-type: none">• Preferred ideas?• Executive summary of committee/public requests | |
| 5. Minutes for this Working Group meeting (deferred to WG#8) | 10 mins |
| 6. Next Steps | |

Working Group #5 Minutes



**West Hamilton-City Accommodation Review
Working Group Meeting #5
March 1 2017- 6:00 pm
Earl Kitchener School
Minutes**

Attendance

Committee Members: John Efthimiadis, Rob Fiedler, Tracy Upham, Barbara Stares, Matt Allen, Tanya Ritchie, Allison Savage, David Heska, Janine Durajlija, Melissa Crawford, Nadine Bernacki, Shelly Turk, Teri Lantagne, Khantavy Sayavon, Sue Caven, Nicole Poyton, Sarah Sirkett, Katherine Graham, Helen Demczuk, Eleni Jalbout, Jennifer Walsom

Committee Member Regrets:

HWDSB Resource Staff: – Superintendent/Chair Sue Dunlop, Mary Finstad, Estella Jones, Steve Johnstone, Sean Malcolmson, Tannis Hamill, Karen Koop, Bob Fex, Gerry Smith, Richelle Bratuz, Dan Ivankovic

Trustees: Jeff Beattie, Christine Bingham, Todd White

Public: 2

Recording Secretary: Sue Phillips

Housekeeping Items

Clarification regarding agenda – if a committee member wants something added to the agenda they can do so by asking and if all are in agreement, it can be added to the agenda

Working Group #4 meeting minutes – approved

Correspondence – 2 pieces

Barbara Stares thanked Nadine Bernacki for her work on alternate options and moved that Nadine presents her options to the committee. Committee agreed by show of hands.

Q. Is there a way for people to present their cases/delegations to the committee?

A. Yes if the committee decided that they would want someone to come in to present. People can also present a delegation to the board. We could also reach out to the individual to ask if their contact information can be shared, thereby allowing a committee member to reach out for information.

Nadine presented her thinking around her options thanking the committee for the opportunity, noting she is honoured to be part of the committee. She also pointed out that we need to remember that the school board has asked us and our communities to put together a long-term vision. My vision is a vision for the future. I understand it is up to the staff to look at the numbers. Even if we have constraints within this process it is I hope we can keep the door open. Keep the community hub a possibility. There are a lot of passionate people working on this process.

No further questions on correspondence.

Q. There seems to be a downsizing of the big schools. How does the government do that? Will they reduce the OTG if you mothball a wing, take away a certain number of classrooms from active use? Will they take that into consideration when they consider overall utilization?

A. Bob – In my experience this has been done. An example of a PTR (prohibitive to repair) project at another school Board was given. I have not seen it happen at a newer school that is not in disrepair. Like most capital projects, there would likely need to be a business case submitted to the Ministry for funding. If the trustees decided they wanted to do that ask they would prepare a report and ask. When instructional school space is physically removed, that portion of its capacity would be removed as it is no longer there.

Q. If we have space available at a school and if we can find a community partner to lease space in that school can we use that space as a way to reduce the OTG?



A. I think there would be consideration on the ministry side if it was used for community use. To be a community partner you must qualify under education system specifics – meet certain criteria conducive to education and the safety of students. The ministry wants us to have community partners as an alternative to occupy spaces.

Q. How many hours a week does the community partner have to occupy the space?

A. I don't think it's built that way – if the partnership aligns with the board's vision I don't think there is a minimum amount.

Q. Comment for Nadine – from a financial point of view the board is suggesting to close Hess St. to save money but your suggestion is to build two additional schools at a tremendous cost. We or the Trustees would have to decide the best use of the ten million it would cost to build those additional schools – would it be best used to spend on the nine schools?

A. Nadine – I'm suggesting a long-term vision. It wouldn't be something that we can engage in now. It is possible next year or even five years.

Q. How is the Dr. Davey community centre viewed?

A. It is not a part of Dr. Davey

Q. Why did we build Dr. Davey for that many (800) students?

A. The decisions that were made at that time were based on enrolments and school consolidations that didn't come to fruition.

Q: If you reached out to community informing them of available space without much interest will there be another attempt to reach out to community once this process is over?

A. If the committee is reaching consensus for the board to explore community hubs more in depth and have specific partners that we might want to approach directly as opposed to the yearly send out, then I think the trustees will hear that and will direct staff to do that. We do our best to reach out to 1000+ organizations/people. They are invited to come forward to hear what is available. We remind you that being in a school means very particular rules and needing to work with the space provided (often a classroom). Some partners might not see it as a viable opportunity. It is different for new builds because you can purpose build it. We are mandated by the province to speak to the communities about potential partnerships.

Q. Beyond community partners is there thought of having space for the purposes of things like the innovation centre?

Comment: In terms of what other drivers there are – the whole issue is what is enough excess space? it is vitally important to have a cushion if we needed it for more people.

Sue Dunlop clarified that the committee is not choosing an option. We are here to talk about the options and hear from the public on what they would like to see in the future.

Option/Analysis

Bob reviewed the options – with discussion from committee

Q. John Efthimiadis, had an opportunity to survey staff at Bennetto and there were comments around improving accessibility and modernization of the facility. Is it possible to get funds to modernize in the current state it is in? On the 1st option where we receive a large chunk of Hess/dual stream school, how would that impact the way the staff/students feel in the building? There are often times we feel we are at capacity.

Additional options

- Open one FI school at Strathcona site and combine Strathcona and Hess Jk-8
- Hess / Strathcona Jk-5 with 6-8 to Ryerson (with a reno at Ryerson) committee wants the info on this option
- Change in Central boundary for 6-8 – all 6-8 at Central go to Queen Victoria instead of Ryerson – committee wants info on this option
- 62 out of catchment to Bennetto
- Those bussed to Ryerson – go to Bennetto



Public Meeting

Sue reviewed the public meeting agenda (from flyer)

What do we want to communicate, how do we communicate, capturing feedback?

- Possible to present pros / cons?
 - Should we approach something like consensus for last working group meeting.
 - Present top-level options
 - Want the public to know the work of the committee
 - Need to make it clear that we don't make the final decision / that we have to present the info to trustees
 - Important we are transparent – present key issues, over capacity, decaying options. Present the initial option again and then the additional options we have come up with, explain potential benefits from possible closure of a school
 - Should we have the option on boards for viewing – people can add their feedback
 - Could we provide people with a questionnaire? No – potential for labour intensive work/different languages
 - Great thing is the opportunity to receive funds to make our schools better – help support student achievement.
- Question for the public – what would you like to see at your child's school? What is your vision of the downtown core / growth? What is their vision of the school's role in the community? Renovation to structure? Resources?

Wrap up

- We have high level on what we want at the public meeting
- We should have another meeting tomorrow at 6:00 p.m. at Queen Victoria.
- Need to be very focussed.

Next Steps

Public Meeting: March 8, 2017 Sir John A. Macdonald School, 6:00 p.m.

Adjourned: 8:40

Working Group #6 Minutes



**West Hamilton-City Accommodation Review
Working Group Meeting #6
March 2 2017- 6:00 pm
Queen Victoria School
Minutes**

Attendance

Committee Members: Eleni Jalbout, Rob Fiedler, Barbara Stares, Matt Allen, Allison Savage, Jennifer Walsom, Melissa Crawford, Nadine Bernacki, Teri Lantagne, Helen Demczuk

Committee Member Regrets: John Efthimiadis, Sarah Sirkett, Jo Anne Cheyne-Miller, Tracy Upham, Tanya Ritchie, David Heska, Janine Durajlija, Shelly Turk, Khantavy Sayavon, Sue Caven, Nicole Poyton, Chantelle Pealey

HWDSB Resource Staff: – Superintendent/Chair Sue Dunlop, Ellen Warling, Steve Johnstone, Bob Fex, Sue Pasion

Trustees: Christine Bingham

Public: Hess St. (1)

Recording Secretary: Teresa Movre

Housekeeping Items

- Review of Hess/Strathcona JK-5 model with Eng 6-8 to Ryerson (FI at Bennetto)
Sue Dunlop reviewed the PowerPoint presentation. Bob Fex reviewed the maps and boundaries of the proposed merged schools. These are options to consider. No decisions have been made.

Q. Where would the new school site be located?

A. TBD

Q. Would the new school be built in the Hess/Strathcona neighbourhoods?

A. The intent is to keep the area walkable, however the site is TBD.

Q. The Bennetto numbers change very little with the additional of FI...Why is that?

A. The enrolment at Bennetto is declining the growth would be coming from the FI program.

- Nadine Bernacki reviewed her latest submission to the committee.

The majority of Sage families live in Strathcona catchment and are highly unlikely to send their children to Bennetto. If the Sage Program was to move highly unlikely the numbers would grow.

Q. Are the five year renewal figures high and urgent?

A. Yes.

Public Meeting #2 preparation

- How do we want to communicate? Sue Dunlop reviewed the slides regarding the Public Meeting.
- Plenty of interpreters will be present- public will need to sit at specific tables if they want interpretation
- Proposed Agenda- 15 minute presentation with a 40 minutes facilitated group feedback
- 25 minute Question and Answer session with a way for people to write questions down if they don't get an opportunity to ask their question within the 25 minutes.
- Interpreters will be present- public will need to sit at specific tables if they want interpretation



- Q. Can we limit the times to one minute to ask question and one minute for response?
A. We can try to encourage to ask a questions and not make a long statement. We will do our best.

- After the 25 minutes- wrap up with if you still have a question at the end of the presentation we can address them at the end of the session

Purpose of Accommodation review

- Why are we here? Keep the language simple.

Advisory Committee Role

- What's their purpose?
- What have they been doing?
- Introduction- Stand as a large group.

Dates

- Summarize the dates.
- Use the timeline graphic- Simplify.
- Summarize dates. Circle where we are.

Support/Concerns

- As a committee this is why we supported this option.

Options to Present

Committee discussion:

- Do you want to choose 2-3 options with some details? Or do you want to have high level options?
 - Discuss the rationale, impact and consequences of each option.
 - Important to understand why we have to do the review? If we don't end up with one of these options this is the consequence.
 - Describe the options we are actively looking at.
 - Timelines so people understand if they need to organize a delegation.
 - Should we talk about consolidation and funding? No closure being one of the options? Yes.
 - Concerns about being too general. We need to be transparent.
 - Identify what the issues are within the nine schools- These are our suggestions- What do you think?
 - We need to gather feedback to help us with our next meetings
 - Specific options-will result in a better conversation around support and concerns
 - When presenting these options we need to remind them they are just ideas.
 - The first option was in detail.
 - Show of hands- detailed options- yes-consensus.
-
- Should we present the new option brought up tonight EK/Central/Ryerson? Consolidation of 3 schools with two new schools to be built on land that we own currently or we have to acquire.



- Central is designated, Earl Kitchener would likely become designated very quickly. Neither site can be built on.
- Not all of the committee is present.
- Timelines are tight to gather necessary data. What if the numbers don't work?
- Address this option as something we are thinking about

A. Status Quo

- No change to all nine schools
- Support: No one is displaced.
- Concern: No access to additional Ministry funding. Facility concerns remain as is. Back in line for renewal.

B. All nine schools stay open with boundary and program changes to balance population

- FI program changes in asterisks
- Support: Redistributes population. Reduces portable need. Not as crowded.
- Concern: Lots of students moving schools. No access to additional Ministry funding.

C. JK-8 Model-Consolidation of Hess/Strathcona with a new school on a location to be determined

- Support: Additional funding possible. New facility instead of repairing older facility. Sibs together.
- Concern: Some disruption. Site is unknown. Relocate students somewhere while build takes place.

D. JK- 5 Model Consolidation of Hess/Strathcona with a new school on a location to be determined (with Central, Hess and Strathcona- going to Ryerson and FI to Bennetto)

- Support: Smaller school community.
- Concern: Relocate students while build takes place. Sibs in two schools.

E. Consolidation of Ryerson/Earl Kitchener/Central to balance population and facility renewal costs

- Support: Address facility renewal costs.
- Concern: Heritage Buildings-Neither Central nor EK site will not be available for a build. Ryerson site would be available

Questions

1. A-E- What do you think of each idea?
2. Is there an idea you prefer and why?
3. What are the three most important things to address at your school? Identify School.

Required for meeting:

Map: Slides on poster board on the walls for review.

For Tables: Grid all maps- 3 ft by 4 ft

Include numbers 1, 5, 10 years out- Add table to the corner of the map. Not required on slides.

Summary: Presentation of the Advisory Committee's work and presentation of the five ideas- may take longer than 15 minutes. We will cover the purpose of the accommodation review, the role of the committee, timeline, the five ideas with support/concerns, Q&A session, and facilitated group feedback to answer the 3 questions.

Public Meeting #2 Minutes



**West Hamilton-City Accommodation Review
Public Meeting #2
March 8 2017- 6:00 pm
Sir John A. Macdonald School
Minutes**

Attendance

Committee Members: Eleni Jalbout, Rob Fiedler, Barbara Stares, Matt Allen, Allison Savage, Jennifer Walsom, Melissa Crawford, Nadine Bernacki, Teri Lantagne, Helen Demczuk, John Efthimiadis, Sarah Sirkett, Tracy Upham, Tanya Ritchie, David Heska, Janine Durajlija, Shelly Turk, Khantavy Sayavon, Sue Caven, **Nicole Poyton**, Chantelle Pealey, Katherin Graham

Committee Member Regrets: Jo Anne Cheyne-Miller

HWDSB Resource Staff: – Superintendent/Chair Sue Dunlop, Director Manny Figueiredo, Dave Anderson, Bob Fex, Jackie Penman, Mary Finstad, Steve Johnson, Tannis Hamill, Gerry Smith, Richelle Bratuz, Estela Jones, Sean Malcolmson, Dan Ivankovic, Karen Koop

Trustees: Chair of the Board Todd White, Trustees Christine Bingham, Larry Pattison, Wes Hicks, Dawn Danko, Penny Deathe,

Public: Hess (43), Central (5), Earl Kitchener (9), Ryerson (4), Strathcona (4), SJAM (5), Queen Victoria (1), Bennetto (3), Community (10)

Recording Secretary: Teresa Movre

6:10 Start Up

Interpreter introductions

Welcomed everyone to the meeting

Introductions: Todd White, Christine Bingham, Larry Pattison, Student Tori, Wes Hicks, Dawn Danko, Penny Deathe, Director Manny F, Dave Anderson, Jackie Penman, Bob Fex, Principals and Vice Principals, PAR Committee. Thanks committee for their dedication and hard work.

Why we are here

- To collect your feedback about the 5 ideas we are going to present to you.
- These are ideas only, no decision has been made. It is very important you give us your feedback.
- There is lots of information on this website: <http://hwdsb.on.ca/reviews/>

- Need to review all nine schools in the area for the future
- Brief presentation
- Question and Answer period- 25 minutes
- Group Work to collect feedback
- Facilitators at each table

Role of the Advisory Committee

- Share information about the community

Review of Timelines

- One more working group meeting on March 2
- Report will be drawn up to give to Trustees
- Trustees will review and make a decision



Review of the Five Ideas

- A-E maps on tables
- A- No schools or boundaries change
- B- No schools close, yes boundary change, yes programs change, open a new FI program at Bennetto
- C- Hess and Strathcona combine into a new K-8 school, location to be determined, and new FI program at Bennetto
- D- Hess and Strathcona combine into a new K-5 school, English to Ryerson in grade 6, location to be determined, new FI program at Bennetto
- E- Central, Earl Kitchener, Ryerson combine into 2 new K-8 schools, Hess and Strathcona combine into a K-8 school, New FI at Bennetto, all locations to be determined

Facilitator will take down all your ideas about these five ideas. If you have other ideas, you can share this with your facilitator.

Question and Answer

Q1. Grades being taught at other schools?

A1. Ryerson is a 6-8 school.

Closing schools will result in young people going to jail. No need to close schools this is not a third world.

Q2. All ideas are fake. Think about the future. Give the land away- the City owns. Are you trying to use us to make your work easier? Or are we trying to help?

A2. We are listening to your feedback. We want to know what you think. All of you.

Q3. Options A & B. Is the purpose of the accommodation review just to get funds? Are options A & B really viable options?

A3. Trustees are very interested in what you are saying and they will consider all ideas.

Q4. If Hess Street was to close are we going to get crossing guards where we need them? Will children be safe walking to school?

A4. Crossing guards are hired by the City of Hamilton. We will work with the City. They look at the number of students to have an increase of crossing guards.

Q5. Are the initial ideas still on the table? Why were they not included in the ideas presented tonight?

A5. Yes. We have already gathered feedback at the first public meeting.

Q6. Why are we only talking about five ideas? Can the initial ideas be put on the table for further discussion?

A6. Yes. But we have already gathered feedback on those ideas. There many pages of excellent feedback posted on the website.

Q7. Does anyone think about the children and the stress of moving schools?

A7. Yes. We all want the best possible facilities for the children now and in the future. There are parents as well as staff on the committee. We understand it can be very emotional and hard to talk about.

Q8. Has the potential West Harbour growth been taken into consideration?

A8. Yes – Note: without knowing the true unit types and counts, it precludes us from capturing true values. Development plans are just in the beginning stages. We have factored this information to the best of our ability. City of Hamilton staff have outlined information about future development.

Q9. Regarding idea E- new schools for Earl Kitchener, Central and Ryerson. If we looked at additions to expand these schools would this be funded as a new school or renovation? Gutting and rebuilding an entire school?

A9. This would be considered a renovation.



Q10. How many schools have been closed in Hamilton? Where does HWDSB rank compared to other Boards in closing schools?

A10. I don't have that information. It can be provided to the committee.

Q11. Clarify what no funding means if the trustees choose option A& B. Capital?

A11. The School Board receives funding from the Ministry for school renewal, and maintenance. There is also funding for Boards to apply for new school builds. In order to apply for the money the schools have to hold a Pupil Accommodation Review.

Q12. What was the initial option from the first staff report?

A12. To close Hess Street School and to redistribute the majority of students to Bennetto and some to Stathcona schools.

Q13. Are Central and Earl Kitchener designated historical buildings and how would this effect a new build?

A13. Central is designated a historical building. Earl Kitchener is not but it is an interest. The schools could potentially be sold and the buyer would be required to follow the guidelines from the City. The buildings cannot be torn down.

We need a school community hub.

Q14. Ultimately the decision is up to the trustees. Will they really look at the committee's recommendations? Will this be made public?

A14. The committee gathers all the information and a report is presented to the trustees. The trustees look at all the ideas and make a decision. Yes, all this information is made public. All minutes are posted on the website.

Q15. Funding comes from consolidation and closing schools. Any options for the trustees to change this process.

A15. Yes, trustees can speak to the Ministry.

Q16. How will parents pick up sick children without a car?

A16. Schools work with parents to figure out a plan.

7:53

Next Steps

Public Delegations- Monday, May 8th, 2017

Submit final report to Trustees in May 2017.

Trustees decision – June 2017.

As part of Hamilton-Wentworth District School Board's (HWDSB) Policy Accommodation Review process, the public is invited to provide feedback on staff recommendations. On March 8, 2017, the West Hamilton community was invited to a community meeting held at Sir John A. Macdonald Secondary School. Attendees were asked to provide HWDSB with feedback through participation in discussion groups about the following five boundary change ideas:

Idea A: No schools close, No boundary changes

Idea B: Balancing Utilization and FI introduced at Bennetto (No schools close, FI at Bennetto, Yes boundary & program changes)

Idea C: Hess/Strathcona JK-8 Merge (site TBD), FI at Bennetto

Idea D: Hess/Strathcona JK-5 Merge (site TBD), 6-8 English at Ryerson, FI at Bennetto

Idea E: Hess/Strathcona JK-8 Merge, Central/Earl Kitchener/Ryerson Merge (sites TBD), FI at Bennetto

Attendees were asked the following three questions based on the five ideas presented:

- What do you think of Ideas A, B, C, D, E? (this question was posed five times, once for each of the ideas)
- Is there an idea you prefer and why?
- What are the three most important things to address at your school? (Attendees were asked to identify the school in their response)

Facilitators supported the discussions at each table by recording the conversations. Facilitator notes were then shared with E-BEST, HWDSB's research department. E-BEST conducted a thematic analysis of the conversations.

In total, 84 community members signed in as participants in the consultation, including representation from Bennetto, Central, Earl Kitchener, Hess Street, Queen Victoria, Ryerson, Sir John A Macdonald, and Strathcona school communities. Members of community groups who provide supports in the West Hamilton community also participated. However, not all participants signed in so it is estimated that over 100 school stakeholders attended the event. Trustees, committee members, and HWDSB staff also attended to support the consultation.

The following is a high level summary of these conversations, highlighting common themes. Please refer to the verbatim notes for further information.

Summary of Findings

What do you think of Idea A? (No schools close, No boundary changes)

- Agree with / like the idea:
 - Children are happy at their current school
 - Current school is easily accessible / close to family home
 - Allows many students to walk to school
 - Idea A is least disruptive to children, families, and staff
 - This is good for vulnerable schools like Hess
 - Keep schools the same because changes are difficult for newcomers (e.g. language barrier, unfamiliarity with city)
 - Like the programs / services offered at the school (e.g. Hess school daycare)
 - Like smaller schools because of the smaller classes
 - Schools will remain community hubs if no changes are made (e.g. keep Hess as a community hub)
- Disagree with / dislike the idea:
 - Idea A is not acceptable

- Changes are needed to solve existing problems (e.g. inadequate play space at Hess, Strathcona, Queen Victoria)
- Idea A doesn't provide access to new building funds from the ministry
- Idea A doesn't address over/underutilization of facilities
 - Doesn't help with overcrowding issues (e.g. Ryerson, Earl Kitchener FI program)
- Idea A doesn't consider states of repair/disrepair of schools
 - Hess Street school will be very costly to repair/renovate
- Other comments:
 - Why is Idea A presented as an option if there is not enough funding available to do the needed renovations at all schools?

What do you think of Idea B? (Balancing Utilization and FI introduced at Bennetto)

- Agree with / like the idea:
 - Addresses overcrowding issues at some schools (e.g. Earl Kitchener, Central, Ryerson)
 - Like that all school remain open
 - Allows for schools to remain as community hubs
 - Changing boundaries and not schools makes sense
 - Like that vulnerable population at Hess Street will not be affected
 - This option allows for future growth
 - Like that FI will be offered at Bennetto with this option
 - Provides advantages for students from different socio-economic backgrounds
- Disagree with / dislike the idea:
 - Don't like the boundary changes
 - will be too disruptive for families (especially newcomers)
 - Doesn't solve overcrowding issues for all schools
 - Families will be negatively impacted; while all existing issues will not be solved
 - Funding implications
 - No Ministry funding will be provided for new build
 - Not likely to receive required funds to address renovation needs at all schools
- Other comments:
 - This option means there will be big changes for FI students
 - Do the boundary changes affect how many students can walk to school? Will Hess still be 100% walkable?
 - Need more information about what programs will change / be offered at each site with this option

What do you think of Idea C? (Hess/Strathcona JK-8 Merge (site TBD), FI at Bennetto)

- Agree with / like the idea:
 - Like the K-8 school model (e.g. helps keep siblings together)
 - Provides more options for social situations
 - Larger student body means more staff and more extracurricular activities for students
 - Like that this option will allow for use of Ministry funding for new build
 - Like the idea of having a new school building with new facilities
 - Addresses the aging facility problems at Hess Street
- Disagree with / dislike the idea:
 - Dislike K-8 school model (e.g. middle school model is better, keeps younger and older students separated)
 - Larger student body means there will be more problems
 - Proximity matters
 - Don't like this idea because not sure where new school will be located
 - Transportation costs are a concern
 - Funding should be used for renovations not rebuilds

- Other comments:
 - o Option C is less favourable than B

What do you think of Idea D? (Hess/Strathcona JK-5 Merge (site TBD), 6-8 English at Ryerson, FI at Bennetto)

- Agree with / like the idea:
 - o Like that Hess / Strathcona remain in the same general area
 - o Like the JK-5 school model
 - Prefer smaller student populations
 - Safer for younger students to be separated from middle school students
- Disagree with / dislike the idea:
 - o Add to overcrowding issues at Ryerson
 - Ryerson would need renovations to accommodate more students
 - o Concerns about student safety crossing busy roads to get to Ryerson
 - o Prefer JK-8 school model
 - JK-5 schools are too disruptive
 - Complicates pick up / drop off for parents who have children at both schools
 - Extra transition for students is not desirable
 - More difficult for newcomers
 - More difficult for parents to attend school meetings at two schools
 - Separates families (doesn't allow for older siblings to care for younger siblings)

What do you think of Idea E? (Hess/Strathcona JK-8 Merge, Central/Earl Kitchener/Ryerson Merge (sites TBD), FI at Bennetto)

- Agree with / like the idea:
 - o Address overcrowding and facility condition needs for all schools
 - o Like idea of getting 2-3 new schools
 - o Like JK-8 school model
 - Allows for siblings to attend one school
 - Less transitions for students
 - More extracurricular and leadership opportunities for students
 - o Like that the schools will still be walkable
- Disagree with / dislike the idea:
 - o It will be negative for the community to lose access to recreation centre
 - o Like JK-5 & 6-8 School Model
 - Middle school experience is positive for many children
 - JK-5 schools are safer for students
 - o Negative impact on proximity of schools to families
 - Many families will lose privilege of living close to their child's school
 - Reduces walkable schools and results in more bussing
 - o Pick up/drop off at larger schools is a concern
 - Amount of traffic congestion around school
 - o Safety concerns
 - Schools will be more spread out geographically
 - Less safe for students to cross busy streets to get to school
 - o Unrealistic option
 - Amount of money required is costly and perhaps prohibitive
 - Cannot close/sell heritage buildings
 - Losing historical schools sites is bad
 - Finding a location/land for new schools will be difficult

- This option is disruptive for all students, staff and community partners in West Hamilton
 - May be difficult to support so many changes at once
- Other Comments:
 - Why is Idea E the only idea that involves Earl Kitchener?

Is there an idea you prefer and why?

- Prefer Idea A
 - But don't expect that things will stay the same
 - Close to home/school is walkable (e.g. good for families without cars, good when walking in bad weather)
 - Support this idea if there is enough funding for all school renovations
 - Like that no schools will close with this option
- Prefer Idea B
 - Fluctuations in enrollment populations can be addressed with this option
 - Like that school renovations can still happen with this option
 - Minimal disruptions to students and staff with this option
 - Like that no schools close, and FI will be at Bennetto
- Prefer Idea A & B
 - Like that community schools are kept open, and no schools are closed
 - Prefer any idea that doesn't involve Hess Street closing
- Prefer A, B or C
 - These options are least disruptive
- Prefer Idea C
 - This option will allow for access to Ministry funding for new build
 - Prefer idea C only if the newly built school is on SJAM property
 - This will allow for school to remain walkable and reduces bussing needs
 - Maintains community relationships and supports
- Prefer Idea D
 - Having a middle school experience helps students transition to secondary school
- Prefer Idea E
 - As long as younger students can get to school safely

Other Suggestions/Ideas:

- Build a new school on the playground at Hess street and tear down existing school
 - Relocate students to SJAM while new school is being built
- Build a new school on the SJAM property / combine JK-8 school with SJAM
- Can FI be offered at Strathcona in addition to Earl Kitchener and Bennetto?
- Like Idea E, but instead of merging Hess and Strathcona, build two new schools for these school communities
- Open a single track FI school in West Hamilton
 - Use Central School as the site

Other Considerations:

- Boundary changes
 - Ensure boundary changes are fair (e.g. if a child lives across the street from a school, they should be able to go to that school)
- JK-8 versus JK-5 & 6-8 School models
 - JK-8 schools are easier for families
 - Easier for pick-up / drop-offs
- Keep Hess Street School Open/Do not close Hess Street School
 - Diversity is a strength of Hess Street school

- Families will experience challenges if school closes
- Hess Street is in a great location (walkable school)
- Hess Street is a model for other schools
- Hess Street School is a vital part of the neighbourhood community
- Hess Street has an open, inclusive and welcoming atmosphere
- Hess Street is a safety net for the community
 - Parents and students are emotionally connected to Hess Street
- Proud of Hess Street school
- Students know and like teachers at Hess
- Larger versus Smaller schools
 - Smaller schools are better because sickness is spread more easily in larger schools
- Location of New School
 - Need to know location of new school in order to make an informed decision
 - Parents would like to have a say in the location of the new school
- Process of receiving funds from the Ministry is flawed
 - Closing schools to access funding doesn't make sense
 - Trustees should advocate for changing Ministry funding process (parents and community members would support trustees in doing this)
 - Would like to receive Ministry funds to renovate existing schools and not just to build new schools
- Programming and Quality instruction is important
 - School location is not as important as quality programming and instruction
- Public Meeting Considerations
 - Please consider changing the location of the final public meeting to make it more accessible for lower city families
- Schools as Community Hubs
 - Community schools are important and keep communities together
 - Community programs help students feel more connected to and engaged with their school
- School Proximity to Families
 - Walkability is important
 - Easier for parents to access schools when they are close to family homes
 - This is important for newcomers who do not have access to cars
 - Unless children choose to attend special programs, they should not be made to travel far distances to their home school
- Tailored Approach is required
 - Change is required at the 9 schools in West Hamilton
 - A tailored, rather than a one-size-fits-all, approach that best meet the needs of students is required
- Transparency
 - School board should have listed all options tonight, not just the new ideas
 - School board should be clear on what is driving the need for accommodation reviews

What are the three most important things to address at your school?

Bennetto:

- Allow schools to have more choice about what is important to them
 - Allow for choice of where to spend money for renovations
- Consider diverse needs of community
- Move assessment centre to be part of school community
 - Promote parent and community involvement

Central:

- Expansion did not include a staff washroom

- Fix accessibility issues in the building
- Need a bigger gym
- Need more space to accommodate all students
- Need more greenspace
 - o More required at back of the school where the students play
 - o Fence front of the school to create more outdoor usable space
 - o Need an area for the students to play soccer
- Need more parking spaces for staff and visitors
- Remove portables

Dr. Davey:

- No green space

Earl Kitchener:

- Need a bigger gym
- Need more space
 - o Need a space for intervention small group, 1:1 meetings, private consultations
- School is too full
 - o Expansion may help

Hess Street School:

- Add a small snack shop onsite
- Fix HVAC issues
- Improve physical plant (e.g. plumbing, windows, washrooms, floors)
 - o Need a bigger gym
- Improvements needed in FSL program
- Listen and respond to the needs of this community
 - o Keep the school as a community hub
 - o Need to be more understanding about family situations
- Need more green space (less pavement)
- Need more support staff (EAs, specialists, Spec. Ed., ESL)
- Open concept design is not idea
- Resurface playground

Queen Victoria School:

- No green space
- Need money for support staff

Ryerson:

- Address overcapacity enrollment issues
- Infrastructure repairs are needed
- More space is required (an expansion is needed)
- Need a private change room for students that is not used by the public
- Remove portables

Strathcona:

- Remove SAGE program
- Renew playground

Questions:

- Accommodation Review Process
 - o What are the principles that will guide the final decision (walkability, community connections)?
 - o Why are so many issues being lumped into one large process? (FI boundaries, new capital, renovations)
 - o Why is Earl Kitchener less of a focus, especially given the age of the building?

- Boundary Changes
 - o Will families be divided between schools with proposed boundary changes?
- Enrollment and Capacity
 - o What will the enrollment numbers / student capacity of the new schools be?
- French Immersion
 - o Do FI projections for Bennetto include drawing in new students from Catholic Board?
 - o Will you consider offering FI in more schools in addition to Bennetto? This might help to keep English a viable program at EK and provide the opportunity for FI for more families.
- Funds for Renovation/Repair
 - o Can the Board tap into the funds from the sale of property to augment the building grants?
 - o How can we retain Hess Street School but get the investments to improve it?
 - o Exactly how many of the “high” and “urgent” renewal needs could be met if Ministry funds are not accessed through school closure?
- New Schools
 - o Will there be adequate green space at the new school sites?
- Parent Involvement
 - o How do parents stay connected in the early years for children’s success?
- School Closure Impact on Students
 - o How does closing small community schools/hubs jive with Hamilton’s motto of being the best place to raise a child?
 - o Has the school board heard what the HESS community/parents are telling them? Do they care more about the money/provincial incentives, than the well-being of the children?
- Staffing
 - o Will the new schools have the same teachers as the current schools?
- Transition Planning
 - o How long does it take to build a new school?
 - o Where would students go during a new build or renovation?
- Transparency
 - o Will public feedback be considered or has the school board already made the decision to close schools?
- Transportation / Walkability
 - o What is the required distance for a student to walk or qualify for bussing?

This report was prepared by the Evidence-Based Education and Services Team (E-BEST).

Public Meeting #2 Activity Feedback - Raw Data

Table Activity Feedback – West Ham. PM#2 – SJAM March 8, 2017

Idea A: what do you think of this idea?

- good idea because we are happy with Hess school daycare etc.
- children are happy and accustomed to the school
- preferred because this is my choice from the start of this process near to my home & accessible for family
- relating to the population
- brand new people are AFRAID of complications for new English speakers – fears of unforeseen problems
- least disruptive to students and families
- maintains sense of community hub for residents
- unless there are specific programs, children shouldn't have to go far
- how do parents stay connected in the early years for children's success – parents need to be involved
- don't want kids to drift away from the community
- no community high school in the area
- problem with "A" doesn't address underutilization or over-utilization or state of disrepair
- keep Hess as a community hub
- more people will come to the area
- not acceptable
- something has to be done
- doesn't solve any concern – overcrowding/building structure/distance
- doesn't access any new build funds
- positive – keep school community
- overcrowding – distance
- positive – vulnerable school such as Hess won't be affected
- changes are needed
- like it but don't expect it will happen
- preferred option
- maintains community hubs
- no disruptions to students, families, staff
- Hess St. School is broken – neglected for 25 years to not close it will cost \$ for renovations
- due to lack of investment in the school (Hess) how can we retain the school but get the investments to improve it
- no money – process from Ministry is flawed
- community hub
- safety of children's a concern
- living in close proximity to school so parent can access
- be clear on the urgent issues that are driving the need for review & possibly losing schools to access funding
- does not address Ryerson enrollment pressures
- does not address EK FI pressures & viability of English program
- like – because keep schools open & keep asset o school – close proximity to school
- Hess Street School our diversity is our strength as our unity makes our uniqueness
- we proud of our school – no closing

Question 1: What do you think of Idea A (no schools close, no boundary changes)

- our school keeps our community together – we are proud of our school, keep it open
- DO NOT CLOSE HESS!! - It is a safety net community Hub great atmosphere open and welcoming great location
- allows for larger number of students to walk to school
- does not represent overcrowding
- good x2
- leaning toward this because – if enough funding for renovation then this would be good
- parent was told not enough funding for all school renovations – how come this idea is presented?
- like idea A, but know schools need renos and expansion
- suggest playground at Hess is big enough to build new school and then tear down school
- why doesn't the parents/community donate money to invest in school instead of government
- like this idea – close to home two at Hess and more on the way – can walk to school & pick them up
- Hess Street works well – why close it – parents and teachers work together & kids learn
- currently the kids are comfortable and know the teachers
- doesn't help any problems
- allows consistency – no disruption
- does not address inadequate play space at both Hess & Strathcona and Q.V.
- questionable financial stability
- good because schools won't close
- don't see the need to close schools
- difficult to get to schools if schools are far away after schools close
- many parents don't have a car
- the mother walks the students to school and they don't have cars. Bad weather makes walking long distances difficult
- many parents are new to the country and don't have licenses
- prefer smaller classes 10 students-1 teachers, not 20 students-1 teacher x2
- school's closing means more students in one school and bigger classes
- the land remains empty after schools close better to have a school on the land
- problems with large number of students in a school and them spreading sickness
- replace existing buildings with new schools

Idea B: what do you think of this idea? (no schools close, boundary & program changes FI at Bennetto)

- seems to be the safest bet – allow for future growth
- schools remain open
- relieve E.K. and Central issues of overpopulation
- supports needs for “community schools” – very important
- just a FI single track school option
- good idea not closing but boundary changes make sense
- stays in community, continued support for families in area
- considering the boundaries need to be discussed for the best outcome for Hess St. School
- love it!

Idea B: what do you think of this idea (no school close, boundary & program changes FI at Bennetto)

- redistribution of F.I.
 - balance out school population when overcrowded
 - boundary changes should reflect fairness (e.g. a school across the street & boundary doesn't allow them to go to that school)
 - better to keep POC where they are because students are part of the program & school community
 - big changes for F.I. students in program & school
 - need more information about how many students at each school
 - positive – community school
 - vulnerable –school such as Hess not affected
 - E.C. & Ryerson overcrowding due to F.I. would be supported
- Negative – no new funding for new build
- doesn't solve any concern of overcrowding
 - impacts a lot of families but doesn't really affect change that is needed - doesn't really solve issues
 - dual track school need to support equal Eng & FI programming
 - second choice
 - keep old schools that represent communities
 - best compromise; over-crowding is eased
- FI @ Bennetto relieves pressure
- will the boundary changes affect families to be divided between schools?
 - no more money renovations a concern for buildings
 - 100% of students walk to Hess will the boundary changes affect transportation (busing)
 - can the school use daycare numbers or other uses to help building the school population? Will Ministry recognize this?
- Like – no schools close therefore retain assets - still live close to school & able to access safely & in short time - it addresses enrollment pressures for EK & FI & Ryerson to some degree by shrinking boundaries
- Dislike – less likely to be able to address renovation needs at schools
- don't like idea of changing boundaries because I've been in Canada 3 years and it's difficult to make changes
 - okay with this option but not with program changes – don't want FI
 - good – no school close, yes boundaries change – program important – want FI
 - important to be at a school Central because of historical nature
 - if change boundaries would it be for smaller or larger area
 - good
 - like this option
 - if boundaries change will it address the South part and numbers – will it lessen the impact
 - if not renovations on south schools will it help
 - like that no schools close
 - don't like boundary change
 - lies new program x 3
 - like FI @ Bennetto
 - takes pressure off EK and Ryerson
 - nice to have additional FI school
 - could Strathcona have FI included? (in addition to Bennetto?)

- like addition of FI to Bennetto – gives students from different socio-economic background an advantage
- in this care, would Strathcona (or any other schools involved) be K-8 – is this an option?
- do not like

Idea C: what do you think of this idea? (Hess & Strathcona combine into JK-8 school, FI at Bennetto)

- why do we keep having meetings if the government has already decided to destroy schools x 2
- not likes because of the different schools that parents would need to go to in order to drop off/pick up children
- the unknown of the location of these new schools makes it difficult to make an informed decision
- dislike of K-8 model – like the middle school model - model keeps sense of community (community oriented)
- like the K-8 model – keep siblings together
- may be challenging in the beginning to create community
- more options for social situations
- more staff = more extracurricular for students, greater support
- in general FI is not a big influence for our new comer families as many of the new children are too old
- this idea depends on location as the families do not know the location so don't know if they can walk to school
- too many students in one big school means too many problems
- what would capacity of the building be?
- would there be program changes in the new school
- new facilities can be positive
- why waste money on new school – use money for renovation
- emotionally connected to Hess School and can't consider an idea of closing Hess school – everything – building & teachers location of school, good for walking 6 min. walk – no car – winter – child pickup
- doesn't like "C" because two schools will be combined and the new school will have a lot of students and the unknown location
- no intention to consider "C" because kids go to Hess and what if I don't know location?
- in settlement period – no car – walk only – school has to be close to home
- important for Hess & Strathcona parents to have a say in new site
- how to find sites for new schools? Because existing sites don't have footprint for JK-8? does it?
- walkability is important for new sites
- LIKE – it provides opportunity for accessing new funding
- what are the potential sites for new build? This makes a difference if closed Hess and built new school in close proximity to Queen St. N.-EK/Ryerson parents – like this option the best
- new build of Hess St. School on Hess St. property (K-8 school)
- combining two schools Strathcona & Hess
- important to keep families together
- consider SJAM property for new build
- difficult to answer without knowing what the new location is
- transportation and cost are a concern
- concerned about a large school (Hess/Strathcona)
- best option depending on school close by
- combine to make it a SJAM site so it would still be a community hub

Idea C: What do you think of this idea (Hess & Strathcona combine into JK-8 school, FI at Bennetto)

- concern – what will be the new site – where – very little potential locations
- I like it
- POS – new school/new build \$/walkability if location is centralize
- new school on Hess site
- where do the students go – during build
- open concept of Hess is difficult
- school over 600 student (new school)
- addresses (problems) – utilization
- spreads FI programming
- addresses facility conditions at Hess
- Question: where would it be? Will parents be able to access the school (to connect)
- transportation for students & for parents to be involved
- adjustment for Strathcona students from K-5 to K-8
- not so good because the location is not determined
- multiple children in one family complicates the travel to/from school
- not comfortable closing 2 schools without knowing where the new build will be – location
- C less favourable than B

Idea D: what do you think of this idea? (Hess & Strathcona JK-5 merge; 6-8 Eng Ryerson; FI at Bennetto)

- issue with students walking over major street York/King Main/Hunter to get to Ryerson
- preference K-8 schools
- removes pressure – Ryerson & Bennetto
- NO NO NO – because older children will be impossible to take care of younger ones
- Ryerson is already over utilized & now there would be more
- too disruptive
- no long term benefits
- concerns about taking students to two different schools (K-5 & 6-8)
- same challenges with C,E – with no location, a decision is uninformed
- prefer K-5 model
- Ryerson already full
- across busy roads through downtown core to go to middle school
- more work for parents to drop off & pick up (if children at 2 schools)
- more work for parents to attend meetings
- too many schools
- with immigrants, new language, too many schools, too many drop offs
- again...we don't know the capacity of the new building...Ryerson seems to be really full & this option means the capacity goes up by 20%
- kindergarten FI concerns – kids having to switch school for grade 1
- doesn't like
- want to know location of new school before approve an idea of new school
- does not want Hess School closed

Idea D: what do you think of this idea? ((Hess & Strathcona JK-5 merge; 6-8 Eng Ryerson; FI at Bennetto)

- better than C because K-5 safer school then with older students
- okay with this idea
- don't like because new school would be too far away & cannot walk
- Ryerson over capacity – would need renovation
- means Strathcona/Hess 6-8 for kids have an extra transition which might not be desirable
- not a viable option
- want JK-8 school
- splitting families up moving 5's to go to Ryerson
- same as C except better that it's smaller
- like the lower age range separate from 6-8
- concerned that separate 6-8 means yet another transition for students
- hesitant to form opinion without knowing actual location
- problematic with children in same family being at different schools
- 3 schools you need to deal with
- K-8 more maturity
- fits into family values having K-8 school
- K-5 get new \$ building
- school size is smaller
- Ryerson – consultation \$available
- presently 6-8 from Strathcona go to Ryerson – 6-8 Hess would still walk
- more likely to get \$ for 2 schools (new & consolidation \$)
- Hess & Strathcona get to remain in their community (area)

Idea E: what do you think of this idea? (Hess & Strathcona combine into JK-8 school; Ryerson, Central Earl Kitchener into 2 JK-8 schools, FI at Bennetto)

- Positive – 2 new schools
- no transition as remain K-8
 - school walkable
- Negative – historic site school – may be very difficult to find locations/add/renovate
- loss of Historical building as school
 - loss middle school model @ Ryerson
 - potential funding may not be possible
 - disruptive for everybody
 - transportation drop-off/pick up a concern
 - difficult to support so many changes at once
 - land concern for new schools
 - a lot of disruption for students & staff
 - but if you don't ask for the money you'll never be sure

Idea E: what do you think of this idea? (Hess & Strathcona combine into JK-8 school; Ryerson, Central, Earl Kitchener into 2 JK-8 schools, F1 at Bennetto)

GOOD – offer new facilities to everyone

-K-8 experience for all student & the benefits that come along (ie more extra-curricular, leadership opportunity fewer transitions)

BAD – leaves City Rec Centre or out school attached viability Rec Ctr.

-cost!! Finding sites; not feasible

-unrealistic – cannot close/sell Central re: heritage designation

-loss of middle school experience which has been very positive for my children (rotary, extra-curriculars, prep for secondary school experience)

-closing “walkable” schools & busing more kids?

-what happens to the grade 6-7-8 in this model

-worst idea because you close 5 schools and open 3 schools for all of downtown – instead put money toward renovations

-Bad – all schools will be K-8 – want K-5 schools because safer for kids

-doesn't like because I picked my house because it is close to school

-if you build K-8 schools the ages of students is wide and this is not appropriate prefer K-5, 6-8

-how long will it take to build a new school?

-I want my 8 children in 1 school

-this idea doesn't say NEW locations...are they new

-without knowing the location of the new school we don't know...hard to get input

-how many more families will be in the EK, C, R area?

-are boundaries changing

-will the new school have the capacity of the 2 smaller schools

-if portables are added there may not be room for playground

-addresses more of the population and the most immediate needs

-where do you put that many new schools?

-seems like a money grab

-most disruptive to the most students, parents, communities

-don't want to sell heritage bldgs.

-negative environmental impact when new builds

NO – same negative impact on Hess St. school as Idea C – still not convenient to families

Like C, except with more schools

-issue with students walking over major street York/King, Main/Hunter

-preference K-8 schools

-remains pressure – Ryerson & Bennetto

Question 6 Is there an idea you prefer most? Why?

Idea B – best option – no school closure

-renos are still on the table

-option for schools in need

A-B because it keeps the community connected to the school

-the school is not closed in these options

-AB or C – less disruptive

Question 6 Is there an idea you prefer most? Why?

- cardinal rule – maintain accessibility for families to schools (especially for people with no cars)
- depends on new build location
- idea is E best as long as younger students can get to school safely (since Central is a historical building – leave younger kids here – build the new school for older kids – grade 3+
- idea A is by far the most popular choice at this table
- their feelings are captured on question 1
- Additional Idea: keep idea E but with keeping Strathcona and Hess as separate schools
- A – 2 votes B C – 1 vote a/c 1 vote D E
- Build new school in playground of Hess and when new school ready tear down the existing school
- idea which doesn't include Hess school closing
- any idea is good as long as Hess stays open
- I prefer A or B – but it seems like these ideas are not going to be used
- Idea C – if building is in SJAM property – maintains walkability - reduces busing - provides building with expanded programming.
- location of Hess or close by SJAM A – 1 C- 7 E one to consider thinking about locations and money released.
- B – addresses funding with minimal disruption to students/staff
- keeps Hess open
- enrolment flux in other boundaries could be absorbed into the B idea
- D 9 votes
- having middle school good for transition to Sec School
- idea C – K-8 ideal building site on SJAM field to keep students in this community

Question 7 -What are the three most important things that need to be addressed at your school?

Identify School

- Hess – should have listed all options tonight – everyone cannot be on website
- responding to needs and preference of that community – what do they say they need
- how much of this time is valuable if not binding it discourages engagement
- presenting and supporting community is critical
- K-8 schools easier to co-ordinate
- 3 different schools to communicate with if all at different schools (pick up/drop offs
- walkable
- large playground – green space
- Queen Vic
- no green space - \$for support staff
- Ryerson
- infrastructure – no portables – private changeroom (not used by public) – more space
- EK
- more space - gym size - no space for intervention small group
- Central
- gym size

Question 7 – what are the three most important things that need to be addressed at your school?

Identify School

Hess: lack of support staff (EAs, specialists, Spec Ed., ESL)

-maintain school as community hub

-improve physical plant (plumbing, windows, washrooms, etc.)

Bennetto: advocate to change funding formula

-allow school to make more choices/have more say over what they need/don't need

Eg choose whether gym is more/less important - transportation

-walkability

-diverse needs of the community

-community hub (SWISH/breakfast program (English as a second language)

-move assessment center to be part of school

-promotes parent & community involvement

-hold Hess St. School as a model for others (schools, politicians to acknowledge the support for families

-Hess is a vital part of the neighbourhood school not to be used for just financial business gain

EK – space for private consultation & 1:1 (one on one workspace for offering computer lab, libraries, gym!!!! Too small

Ryerson – portables/enrollment over capacity

Hess – open concept school design not ideal - lack of green space

Dr. Davey & Queen Vic– lack of green space

Other Ideas – additional ideas

-build new K-8 elementary school on SJAM

-Move Ryerson students into site

-demolish and rebuild Ryerson

-return to new Ryerson

-move Hess & Strathcona to new building

2 New schools – longer timeframe

New Idea

-change Central school to a single track F1 school

English to QV – phase out each grade by year, by attrition

Hess – playground should be levelled, maintenance – floors – playground levelled

Central – expansion doesn't have washroom – have to take teacher's swip card & dress warm

-Like because historical building

-close to home for walking

Hess – safety walking distance

-like teachers/atmosphere/inclusion

Strathcona: addition of F.I.

-remove SAGE

-playground renewal

Hess

-playground resurface

Hess – green space

-open concept on upper floor – issue

HUAC issues – fix now

Question 7: What are 3 most important things that need to be addressed at your school? Identify school.

Central – green space in back where kids play

-fence front to create more outdoor usable space

-fix accessibility issues in building

Location – Hess St. School

-improvement in FSL delivery/program

-school yard – more grass & less pavement

-small shop for snacks (tuck) would be nice

The parent community understands that no funding will be available to make renovations, so they decided NOT to address renovation/renewal ideas in this discussion

-accessibility for families (especially those without cars)

Hess – renovations

EK – too full – expansion would help

-overcrowding will be resolved in Option A by 2019

Ryerson – portables

-burnt out structure

-an addition should be made

Central

-make rooms – too many portables

-need a facility with enough accommodation for all students

-parking is an issue – not enough parking for parents/staff – more parking

-this causes frustration and sometimes

-need a safer outdoor activity space for students – soccer area outside

HESS Street School

-more understanding about family situation

- a lot of Vietnamese community altered school – why don't more parents come out to public meetings

-dad works a long ways away – it takes an hour for them to get to school to pick up children

-no child care income too low

-some need a walkable school

-if the school closes it will cause many more challenges for family (not just his family – many families are similar)

-Hess is accessible and cozy to get to for new comers

-don't make life more challenging for new comers

Keep Hess Street School open

HESS School

-what will be done with the population growth in the area

-why are we looking at closing schools

-would like a new playground, new building, elevator, etc.

-can there be one school that can accommodate students of all needs

-difficulties travelling to student's schools, some parents aren't very familiar with getting around the city

-having students go to one school instead of having to go to various schools

HESS Street School – no idea – new gym floor

-bigger gym

Question 7: What are 3 most important things that need to be addressed at your school? Identify school.

HESS Street School – we come from a very poor country and Hess St. is beautiful

SJAM – everything is okay

Questions

-do the parents realize they can come into the school? These parents are taking language and working and can't see inside the school. Please ask the students.

-why do you have to close 2 schools to make 1 school?

-what would be the capacity of the new schools?

-if 2 school became 1, will the same teachers be at the new school?

-is there a certain number of km's a student gets a bus from?

-if there are new schools being built how does the physical health of the children fit in ... green space/playground

-for the final public meeting, please consider the location and accessibility for lower city families to attend

-what are the principles that will guide the final decision? walkability & connection

-why are we lumping in a range of issues into one large process? ie/ FI boundaries, new capital, reno

-do FI projections for Bennetto any change ingrowth to enrollment due to drawing new students from Catholic Board?

-will you consider offering FI in more schools in addition to Bennetto? This might help to keep English a viable program in EK? And provides the opportunity for FI for more families?

What is the student Engagement process? Can we try to ensure that this conversation happens in content of development of community HUBS?

So it is part of the public record...I'd like to know what these issues of bricks and mortar are being contemplated in the absence of a discussion of programming, quality educators and best preparing our kids for a future that is vastly different than today? I don't care about locations as long as you maximize my child's ability to learn.

-Has anybody thought about asking the children what they want? They are a big part of this and deserve to be part of the discussion. Maybe they want familiarity and security over new and flashy in a strange place.

-Why is Idea E the only idea that involves Earl Kitchener? (Hess Street)

-Why is Earl Kitchener less of a focus, especially given the aged building? (Hess)

-How does closing small community schools/hubs jive with Hamilton's motto of being the best place to raise a child? (HESS)

-Have they heard what HESS community/parents are telling them? Do they care more about the money/provincial incentives, than the well-being of the children?

-Exactly how many of the "high" and "urgent" renewal needs could be met if Ministry funds are not accessed through school closure?

-If schools are closed and new buildings are erected, will the students stay at their schools until the new schools are build or will they be a transferred temporarily to a school that is staying open?

- Should we be focussing our energies on demanding that our provincial & federal governments re-vamp the funding allocations so that it's not an either/or, that school boards can access funds for both renovations and new schools

Questions

- Idea B – What programs in which schools would be changed?
- Where would the English 6-8 in Idea D go?
- Why can't we access the new/additional funds for renovating the older schools, keeping them open?
The suggestion being that unless we build new schools we can't access the funds.
- What happened to the idea of community schools?
- Renovate & update?
- In my understanding of academic researching middle school models, the stand-alone middle school seems to provide benefits to kids transitioning between elementary and high school (academic and social pay benefits). It seems that therefore, refraining stand-alone middle schools rather than adding K-8 would more robustly support children in grades 6-8. Does the Board agree? What educational research backs this up?
- Is any city-owned property an option for a school?
- How does closing small community schools/hubs jive with Hamilton's motto of being the best place to raise children?
- Can the Board tap into the funds from the sale of property to augment the building grants?
- Why can't the Board utilize the "under-utilized", inefficient properties for other purposes, ie bring back the concept of community schools from the 1970's?

Other Ideas

- high performing facilities where student/children can grow and excel
 - perhaps use the building of SJAM to house HESS St. students while the HESS St. site is renovated – then move them back into a renewed HESS St. School
 - keep HESS open – had a public meeting to advocate at SJAM gym
 - I would like to see the trustees advocate provincially to change the funding structure in order to better reflect our community needs. Parents and community member would not only support you, they would likely join
- In all consideration there definitely needs to be change but for each of the 9 schools needs are not necessarily the same. Some need less students, more students, more programs, more teachers, new buildings, even funding for better opportunities. Those that do not learn from their mistakes, are doomed to repeat them.

Correspondence

From: Larry Pattison [Trustee]
Sent: Thursday, March 2, 2017 1:01 PM
To: Sue Phillips [Staff]; Sue Dunlop [Staff]; Christine Bingham [Trustee]; Todd White [Trustee]; Jeff Beattie [Trustee]
Subject: Re: Map revisions from WG#5 March 1st presentation

Thank you very much, Sue. Can I request the following as well. I am putting a spreadsheet together to help me understand all the various tables from the many documents and I need a few numbers for what I am looking to achieve from my interpretation of the data.

Questions
1. FI numbers for Bennetto from the FI Boundary Review. ie. how numbers would change for EK, Ryerson, and Bennetto under that initial review the way the schools are today. If this has already been provided my apologies. Lot's of data to mine.
2. AOTG for all schools - Actual on the ground capacity based on how we utilize the space in these schools today. This was done for me for Memorial City when I was asking about FI there. ie if the OTG is 321, is the AOTG with SpecED and other rooms, say 250?
3. FI transportation now for EK and Ryerson - Please tell me where I can find these numbers. I see the English track ridership details but not FI.
4. Proposed transportation after FI change - if all we were to do was just change FI boundaries, how does that change our French transportation numbers?
5. PDF with all files broken down like our binders - this would give us one place for everything. Keep individual links for each meeting as well but we can create an online binder broken down just like our hard copy for easier searching of text across all data that has been shared with us.

It's not easy to know where we (Trustees) can ask for information but it's no good asking for this after people are set on an option. I did ask for the AOTG before so if I could have this, I will share my spreadsheet with you once completed.

Regards,

Larry

Larry Pattison
Ward 3 Trustee
Hamilton-Wentworth District School Board
20 Education Court, P.O. Box 2558
Hamilton ON L8N 3L1

T: 289.689.2870

lpattiso@hwdsb.on.ca

From: Tanya Ritchie
Sent: March 6, 2017 3:17 PM
To: Teresa Movre [Staff]
Subject: West Hamilton Accommodation Review

Hello Sue,

Today is Monday, March 6th, and I am writing about two distinct issues relating to the HWDSB West Hamilton Accommodation Review. I would like for this correspondence to be shared with the working group in our next meeting on March 22nd.

Firstly, I feel that we have not covered this subject as thoroughly as we need to have done at this stage in the process. There is still a significant lack of understanding of our options within our group, and in the wider community. According to the Pupil Accommodation Review Timeline laid out in our binder, there must be "a minimum of 40 business days to a maximum of 60 business days between the first and final public meetings" - which gives us until April 4th to hold another public meeting.

Furthermore, I don't believe that one working group meeting after the final public meeting (if another one is not scheduled) will be enough to cover any and all concerns which may be raised by the public. I think it is a disservice to the wider community to imagine we can address all their concerns in one meeting.

I therefore propose that we add, at the very least, one more working group meeting after March 22nd, and preferably more than that - as well as another public meeting.

The second subject I wanted to raise is one that we have barely mentioned during our working group, but one that I think should be discussed. That is that we have been told - quite clearly and plainly - by staff that the HWDSB is underfunded in terms of regular maintenance and upkeep of the existing schools. Therefore, the only financially viable way to adequately accommodate Hamilton students is to continually "consolidate" schools.

This consolidation means that schools become larger and further apart. This is precisely the opposite of what parents, educators and students feel is good for the educational, emotional and physical well-being of students and their families. It is absurd on its face that the HWDSB continues to acquiesce to this Provincial funding model.

Just about every ARC that has taken place in Hamilton has involved controversial school closures. Many of these closures have rightly been met with angry protests from teachers and families. The role of the HWDSB is to provide the best possible education and educational environment for students, and the best workplace possible for educational staff. This role is not fulfilled by simply being a conduit for the unreasonable demands of the Provincial government.

I urge Trustees and HWDSB staff in the strongest possible terms to cease with this consolidation practice and to fight the Province if necessary to change their funding model. If our schools were well maintained, this sort of precipitous review process and dramatic change would not be necessary, and could be replaced by a gradual, gentle and occasional tweaking of catchment boundaries.

I thank you for your consideration.

Sincerely

Tanya Ritchie
Dr Davey

March 9, 2017

Dear Trustee,

I do not support the closing of Hess Street School. Following are my reasons:

1. Many immigrant communities see their local school as a gathering place.
2. Children are able to take advantage of after-school programs and sports activities.
3. As a former teacher at Bennetto School, when Robert Land students were bused in, the children were not able to stay after school and the parents rarely joined in after hour activities.

Please vote "no" to closing Hess Street School.

Kind regards,

Isabella M

March 9, 2017

To whom this may concern,
I work for the YMCA Education and Immigrant Services located at 25 Main St. W. Our job here is to receive and assess newcomers to Canada and to help them receive education to better their lives and the lives of their children. We are seeing more and more new immigrants coming to, not only this country, but to our city of Hamilton. Many are choosing Hamilton because of its diversity, its reasonable standard of living since many of them come with very little. Our adult schools are full and now I hear that you wish to close Hess School. It saddens me to hear this since many of our clients live in the Hess School vicinity. They worry about their children assimilating or fitting in. Perhaps you are concerned about the numbers and yes the cost and the money that you will save, but please consider the human part of this. Creating a larger school is not necessarily the best solution for these young, future Canadians who might require special attention or even our own young Canadian children who will be just a part of a bigger number. Bigger is not always better. Please look at the stats of other school closures and you will see that 200 children are better looked after than a school filled with 400 children. My thoughts...someone who's been there.
Thank you!

Maria C

March 9, 2017

Good morning,

Listening to the parents from different schools discussing the "ideas" put forward at the Public Meeting last night, the only one that is acceptable is B. It is unreasonable to expect people to support ideas C or D without knowing where a new school might be located.

I understand that the Initial Option - close only Hess and bus the children to Bennetto - still holds and is the only "option" on the table. The Hess parents have described the hardships and disadvantages to their children now at 3 public forums but it does not seem as if their voices are being heard. Are children whose parents speak in broken English less important?

Elizabeth S

Comment, re: West Hamilton City Accommodation Review (AR)

Superintendent Dunlop and members of the accommodation review committee (ARC), the Bennetto Parent Council would like to take this opportunity to comment on the pupil accommodation review (PAR) currently underway for 9 schools, including ours, in West Hamilton City.

Specifically, we would like to express our opposition to closing schools unless there is a compelling rationale and broad consensus for doing so. We also wish to convey our support for opening a new French Immersion (FI) program to serve students in the northern and eastern parts of the AR study area.

As HWDSB staff, trustees, and ARC members may be aware, the North End is in the midst of significant change. It is unclear if the potential for future growth in families with children has been adequately incorporated in the projections being relied upon in the PAR. We are aware that most, if not all, of the neighbourhoods included in the PAR are in a similar position, but we'd like to highlight and emphasize our situation.

In recent decades, the City of Hamilton has invested in major parks in the West Harbour and North End residents have fought for a traffic management plan to calm traffic to ensure that as large-scale residential developments on Pier 8 and Barton-Tiffany proceed our neighbourhood remains walkable and safe, especially for children. There is also significant renovation activity occurring and the area is viewed as a desirable place to raise children.

It is unclear if the changes underway are being reflected in data or enrollment numbers as the changes being experienced are multi-faceted and in the immediate term some families are being displaced due to rising rents and the decision by CityHousing Hamilton to leave many family-sized units in its Jamesville complex vacant in advance of what is being characterized as a revitalization project that involve significant residential intensification.

For these reasons we believe the AR should be cautious in "right-sizing" capacity in West Hamilton City, particularly with regard to those schools located in neighbourhoods that are part of the planning area covered by the West Harbour Secondary Plan (i.e. Setting Sail).

It is our understanding that HWDSB trustees approved a report last summer that recommended the phased opening of a new FI program at Bennetto Elementary School.

We support this as an outcome of the AR as it would not only increase enrollment at our school to ensure the facility remains well utilized, but will also improve access to FI for students in our catchment and those of nearby schools, which serve social and economically diverse communities.

The addition of FI would complement other initiatives (recent and underway) to make the Bennetto Elementary School more of a community hub and support and enhance the learning environment for students and staff. Two examples among many: over the last couple of years we have directed considerable effort toward planning and fundraising for outdoor play area improvements and have been working in collaboration with No.9 (Toronto-based non-profit arts and design organization) to develop a

series of small projects to make this achievable as resources permit; and the addition of before and after school childcare run by the Jamesville Children's Centre using one of the kindergarten classrooms.

We'd like to express our appreciation to HWDSB staff and members of the ARC for their efforts to ensure that students (our future) are well-served by this process.

Sincerely,

Bennetto Parent Council

March 19, 2017

To HWDSB Trustees and Accommodation Review Committee,

Ahead of our meeting on Wednesday night I want to summarize some of my thoughts regarding our work to date.

We have heard clearly from the public and committee members priorities such as walkable schools, schools that function as community hubs, and well maintained facilities/play spaces. This is what I want for my daughter at Hess St School and for all students at the 9 schools in this area.

However, I'm disappointed that poor decisions made in the past decade and incomplete enrollment projections are restricting our ability to develop a vision for what we want our schools to look like in 25 years. The fact that 3 schools have been rebuilt since 2006 with capacity for ~800 students while today each of these schools is underutilized reveals poor HWDSB planning. The admission from HWDSB staff that the new developments at Pier 7/8 and Barton-Tiffany are not included in future enrollment projections also inhibits our planning ability.

Notwithstanding these concerns, I have always felt that the initial option to close Hess and bus students to Bennetto was ill-conceived. My preference has been to keep all 9 schools open. The current enrollment in the 9 schools is a healthy 82%. Redistributing the catchment boundaries so that schools are more balanced (rather than some at 63%, while others are at 120%) will be difficult, but it will maintain the current walkability, will not negatively impact existing communities, and it will preserve the existing local neighbourhood schools.

I recognize that financial constraints will likely be one of the most critical factors in this decision-making process, and as a result I think the second best option is this:

- To build a new Kindergarten to Grade 8 school on the Sir John A Macdonald soccer field to replace Hess St School and Strathcona

While not perfect, this will provide a new school and maintain walkable communities for a large majority.

I'd like to conclude with some recommendations for the next Pupil Accomodation Review process:

- a) Include more information in the initial report rather than providing additional information to the committee mid-way into the process. Information such as which schools are designated or listed as heritage sites, already proposed French Immersion boundary adjustments and bus information.
- b) Provide as an appendix to the initial report a summary of special programs that occur at each school (rather than verbally presenting this at Meeting #2 and not including it in the minutes).
- c) Explain more clearly the different "pots of money" that funding comes from. The fact that the current provincial funding model is flawed and completely separates transportation costs, school capital renewal costs, and new school construction costs should be stated up-front.
- d) Explain more clearly what "On The Ground" (OTG) capacity is and how it's calculated
- e) Make public the current "Learning Opportunities Plan" rather than treating this as "sensitive confidential information".

Sincerely,

David Heska

heskad@gmail.com

Expanded Option for PAR 2017 West Hamilton City Elementary Schools
by Nadine Bernacki, March 9th, 2017:

SUMMARY:

Move Central boundaries to transfer some Central and Ryerson students to Queen Victoria School to reduce population pressure on Central and Ryerson.

Move French Immersion boundary to anything outside of the new boundary encircling EK and Central Schools. Second French Immersion program to be started at Bennetto.

Move the Ryerson boundary to include only EK and Central School catchment areas.

Close Hess and Strathcona and build a JK-8 school, with 500 pupil places maximum, on a site to be determined (Central Park, Victoria Park, SJAM site, or other site) to have new buildings which meet benchmark and accessibility requirements, keep close communities and siblings together, reduce renewal costs, and accommodate generous play spaces. A community hub with a recreation centre (and an indoor pool with hot pool) is also needed and could be created for these neighbourhoods.

Close Central, Earl Kitchener, and Ryerson and build 2 JK-8 schools to replace them on sites TBD (Ryerson site, Earl Kitchener site with additional lands, Chedoke Golf Course site, other tbd)... to have new buildings which meet benchmark and accessibility and safety requirements, keeping close communities and siblings together, reducing renewal costs, and accommodating generous play spaces.

Move SAGE and SAGE Quest programs together to Bennetto school to help optimize utilization at that site and to keep the SAGE siblings together at one school and to not create a school larger than 500 at Strathcona & Hess.

Move Hess/Strathcona eastern boundary to Bay Street to transfer pupils to Dr. Davey to reduce size of new Hess/Strathcona school to a maximum 500 pupil places.

Using SCC money to meet the renewal and benchmark items via the consolidation of schools will allow the board to fully renew Bennetto school and bring all of the schools in our area up to date with available funds from other Ministry of Education funds.

Use proceeds from any sale of surplus lands or buildings and/or any other money we can get our hands on to build a new school at Mars Ave and Cheever Streets in the Keith neighbourhood to accommodate 500 students (JK-8) with at least 6 acres adjoining the community park and buying out the auto recycling place and the empty former Studebaker lot. (Hopefully this can be redeveloped residential around the new school site).

Redistribute the boundaries of the Dr. Davey, Queen Victoria, C. Wever, and Keith Schools as it makes the most community and walkable sense to accommodate approximately 520 students each. Seek out community partners to take over the surplus space specifically in the buildings of Dr. Davey, Q. Vic., and C. Wever as needed and possible to improve utilization over the four schools. Government of Ontario funding is available for development of community hubs.

PART ONE:

Earl Kitchener, Central, and Ryerson Catchment Boundaries

1. Move eastern catchment boundary for Central to James St., northern boundary to Main St.
 - *students will not have to cross James Street*
 - *students will not have to cross Main Street after LRT construction (probably less than two students affected)*
 - *lines up boundary with Earl Kitchener northern boundary (makes sense)*
 - *reduce population pressure at Central AND Ryerson, estimated 50 students from Central and 30 from Ryerson to Queen Victoria*
Central: $304-50=254/283=90\%$
2. Ryerson 6-8 catchment boundaries moved to include new Central boundaries
 - *makes sense to keep Central and EK kids together and not have to bring in students from other areas when the school is already overfull.*
Ryerson impact: $410-30*\text{estimated}=380/343=110\%$
Queen Victoria impact: $557+50(k-5)+30(6-8)=637, 637/758=84\%$

PART TWO:

French Immersion Boundary for EK and Ryerson

3. With respect to new catchment boundaries listed above move French Immersion Boundary for any students residing outside of the EK and Central catchments to be accommodated at a new French Immersion program location at Bennetto school
 - *creates greater convenience for students in North End of City to participate in French Immersion*
 - *relieves student population pressure from EK and Ryerson*
EK Impact: $561-54=507/548=93\%$
Ryerson Impact: $380-15=365/343=106\%$
Bennetto Impact: $497+54(k-5\text{ FI})+15(6-8\text{ FI})=566/744=76\%$

PART THREE:

Strathcona and Hess Schools

4. Merge the populations of Strathcona and Hess St. schools into a new JK-8 school on a TBD site with generous play space and green space, (former locations as possible community hubs/rec. Ctrs)
 - *keep Hess Students in walkable Strathcona neighbourhood where they live*
 - *create generous outdoor play spaces for both Hess and Strathcona students, both which are currently lacking*
 - *create space for community hub and recreation centre in Strathcona neighbourhoods*
 - *improved facilities for both Strathcona and Hess students*
 - *improved ability of HWDSB to financially sustain these two schools as well as others*
 - *creates opportunity for community cohesion across socio-economic backgrounds by including more diversity into both school populations*
 - *ideally keep this school to less than 500 students to help create cohesion in diversity at this school*
Strathcona Impact: $188-188=0$ - closed
Hess St. Impact: $346-346=0$ - closed
New School for Strathcona and Hess Students
New School: $188(K-5)+346(K-8)=534$

PART FOUR:

Other boundary and program movement

5. Grade 6-8 students from former Strathcona catchment at Ryerson to transfer to New Strathcona/Hess school

- *makes sense to keep the JK-8 children from Hess with the JK-8 children from Strathcona – it could detrimentally affect kids who have bonded to each other to split them up in Grade six.*

New School Impact: 534+55=589

Ryerson Impact: 365-55=310/343=90%

6. Move SAGE and SAGE Quest Programs to Bennetto School

- *create cohesion between JK-8 SAGE programs in one location*
- *create opportunity for Bennetto children to participate in this program*
- *reduces size of facility needed for strathcona/hess school*
- *improves utilization of Bennetto facility*

New School Impact: 589-63=526

Ryerson Impact: 310-43=267, 267/343=78%

Bennetto Impact: 566+63+43=672, 672/744= 90%

7. Move western catchment boundary of Dr. Davey to Bay Street to transfer some New Strathcona/Hess school students to Dr. Davey ~ 60 students

- *reduces size of facility needed for strathcona/hess school to help facilitation of cohesion*

New School Impact: 526-60=466, 466/500=93%

Dr. Davey Impact: 518+60=578, 578/816=71%

PART FIVE:

Renewal of Kirkendall and Durand Schools

8. Combine the populations of Central, Earl Kitchener, and Ryerson Schools to become two new jk-8 schools (one with French Immersion) to replace all three of those schools

- *provide new facilities meeting all accessibility and benchmark requirements for all of these students*
- *provide generous outdoor play space and gym space for all students*
- *provide change rooms for students at the Ryerson Recreation Centre independent of public change rooms*

CENTRAL=254, 90%

RYERSON=267, 78%

EK=507, 93%

Total of 1028 students could be merged into two jk-8 schools, both with OTG capacities of about 525 students.

NEW Kirkendall School= 514 students, 514/525= 98%

NEW Durand School= 514 students, 514/525= 98%

PART SIX:

New Keith School and rebalance and right-sizing student community populations at Queen Victoria, Dr. Davey, and Cathy Wever Schools

8. New school built in Keith neighbourhood (possibly at vacant land and the intersection of Mars Ave. and Cheever St., adjoining community park and possibly buying out the scrap yard that is currently there)

- *Provides walkable school for the Keith Neighbourhood and restores the heart of the Keith community*

- allows for re-sizing large students populations at C. Wever, Q. Vic., and Dr. Davey
- provides play fields for students in this community
- find community partners to right-size oversized schools using Government of Ontario funding for community hubs

School Enrollment Projections for Changes proposed Parts 1-6

	OTG	2016 enrol	% cap.	Pt 1	Pt 2	Pt 3	Pt 4	Pt 5	Pt 6	New 2016 Enrol.	New OTG	New Capacity
Bennetto	744	497	67%		+54 +15 =566		+63 +43 =672		672-150=522	522	744	70%
Cathy Wever	800	714	89%						714-194=520	520	800	65%
Central	283	304	107 %	-50 =254				-254 =0		0	0	-
Dr. Davey	816	518	63%				+60 =578		578-58=520	520	816	64%
E.K.	548	561	102 %		-54 =507			-507 =0		0	0	-
Hess Street	450	346	77%			-346 =0				0	0	-
Queen Victoria	758	557	73%	+50 +30 =637					637-117=520	520	758	69%
Ryerson	343	410	120 %	-30 =380	-15 =365		-55=310 -43=267	-267 =0		0	0	-
Strathcona	245	188	77%			-188 =0				0	0	-
New Hess						+346 +188 =534	+55=589 -63=526 -60=466			466	500	93%
New Durand								+514 =514		514	525	98%
New Kirken-dall								+514 =514		514	525	98%
New Keith									+150+194+58 +117=519	519	525	99%
Totals	4987	4095	82%				4095			4095	5193	79%

Financial Results of suggested changes

	Accessibility, Benchmarks where possible, and high and urgent renewal needs	With proposed changes	Difference			
Bennetto 1966	2,714,270	2,714,270	keep			
Cathy Wever 2006	325,244	325,244	keep			
Central 1851	2,933,208	0	Keep for Board use?			
Dr. Davey 2010	295,313	295,313	keep			
Earl Kitchener 1915	8,167,987	0	Close and re-use?			
Hess Street 1974	4,996,854	0	Sell?			
Q. Victoria 2009	115,890	115,890	keep			
Ryerson 1975	560,053	0	re-use			
Strathcona 1956	2,305,110	0	Sell?			
New Hess	0	10000000	build	Use land we already have?		
New Kirk	0	10000000	build	Possibly acquire land?		
New Durand	0	10000000	build	Use land we already have?		
New Keith	0	10000000	Build	Acquire land?		
Totals to come from SRG	22,413,929	3,450,717				
Totals to come from SCC	0	40,000,000				

From: Nadine Bernacki

Sent: March 9, 2017 2:28 PM

To: Accommodation Reviews

Subject: some maps for your perusal to go with the expanded option of Mar 8 I sent earlier...

Found the proposed site plan today for the vacant land at the end of Cheever St. and Mars Ave (Mars and Cheever Industrial Park map.pdf). Looks like it wouldn't be too hard to get a hold of some land for a school right where I suggested for the New Keith School (see Possible new Keith location A.pdf). Maybe they could even call it the Studebaker School or something like that. May need some remediation.

Also attaching a map for possible site expansion if there was appetite to expand and rebuild on the current EK site (Possible new EK school with property additions.pdf). Or if they don't want to tear anything down, there's this spot at the Chedoke Golf Course. (Possible new EK Location B.pdf)

A map of a possible new location for Strathcona/Hess (Possible new Hess and Strathcona location.pdf) if there was an appetite to choose a more central location than the edge of the catchment or obvious choice of SJAM site for walkability reasons. I wonder if the city would consider a trade for the current Strathcona location so they could build a rec ctr there.

See you all on the 22nd!!

Nadine Bernacki

--

*"When you change the way you look at things, the things you look at change."
Wayne Dyer*



Possible new EK school with additions

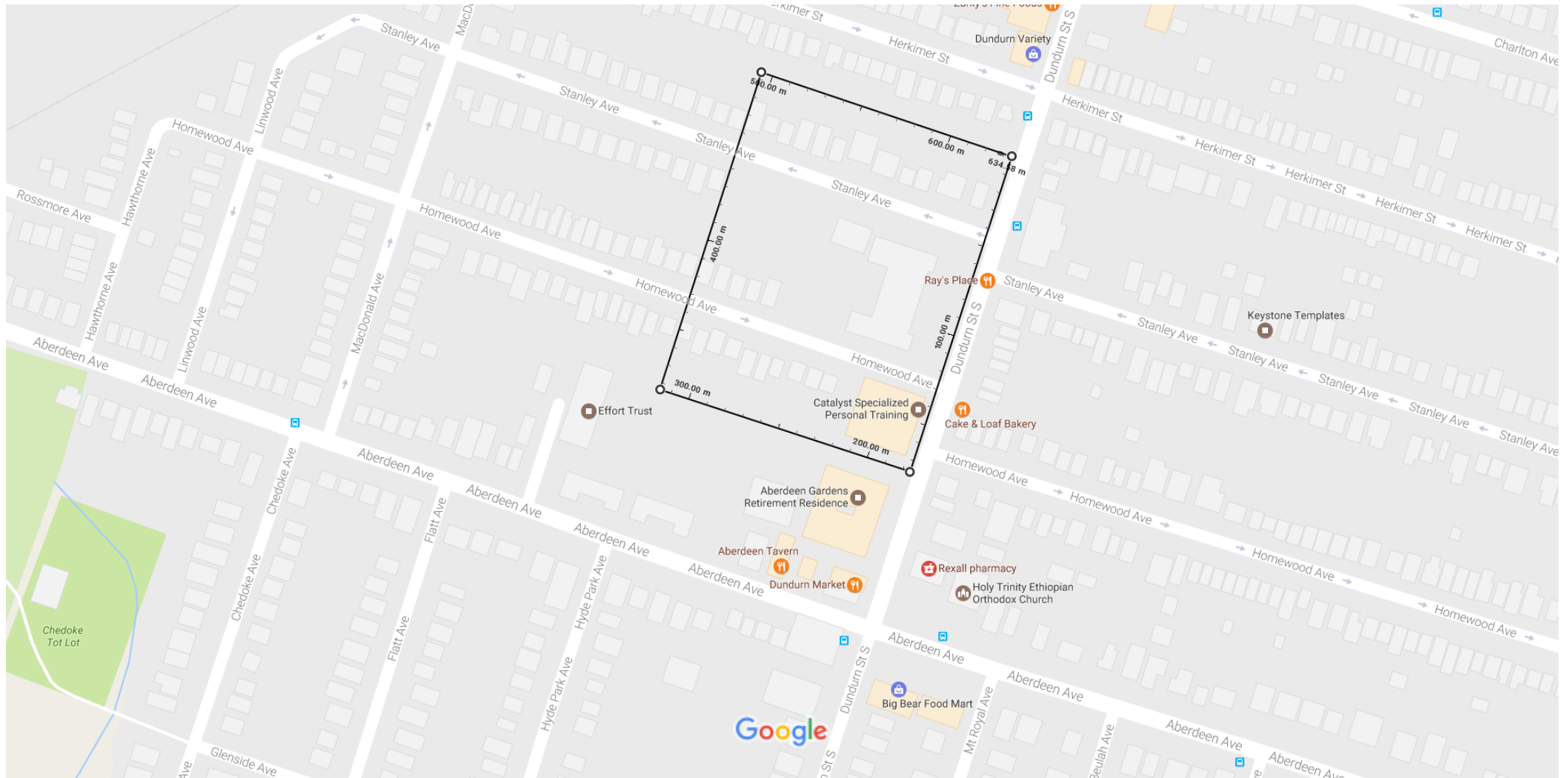

Map data ©2017 Google 50 m

Measure distance
Total area: 24,837.01 m² (267,343.34 ft²)
Total distance: 634.58 m (2,081.97 ft)

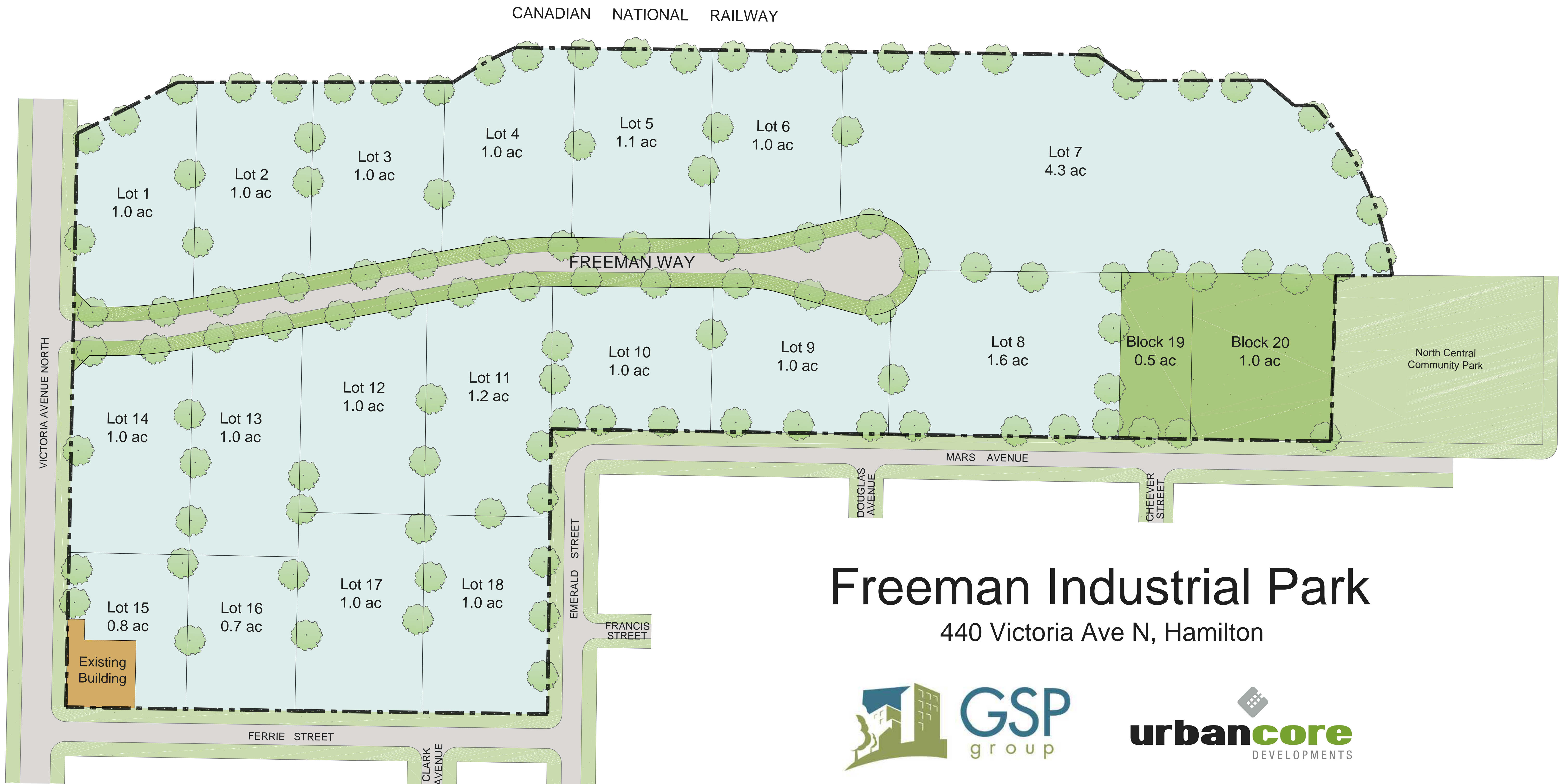

Freeman Industrial Park

440 Victoria Ave N, Hamilton





Possible suggested location for new Keith School

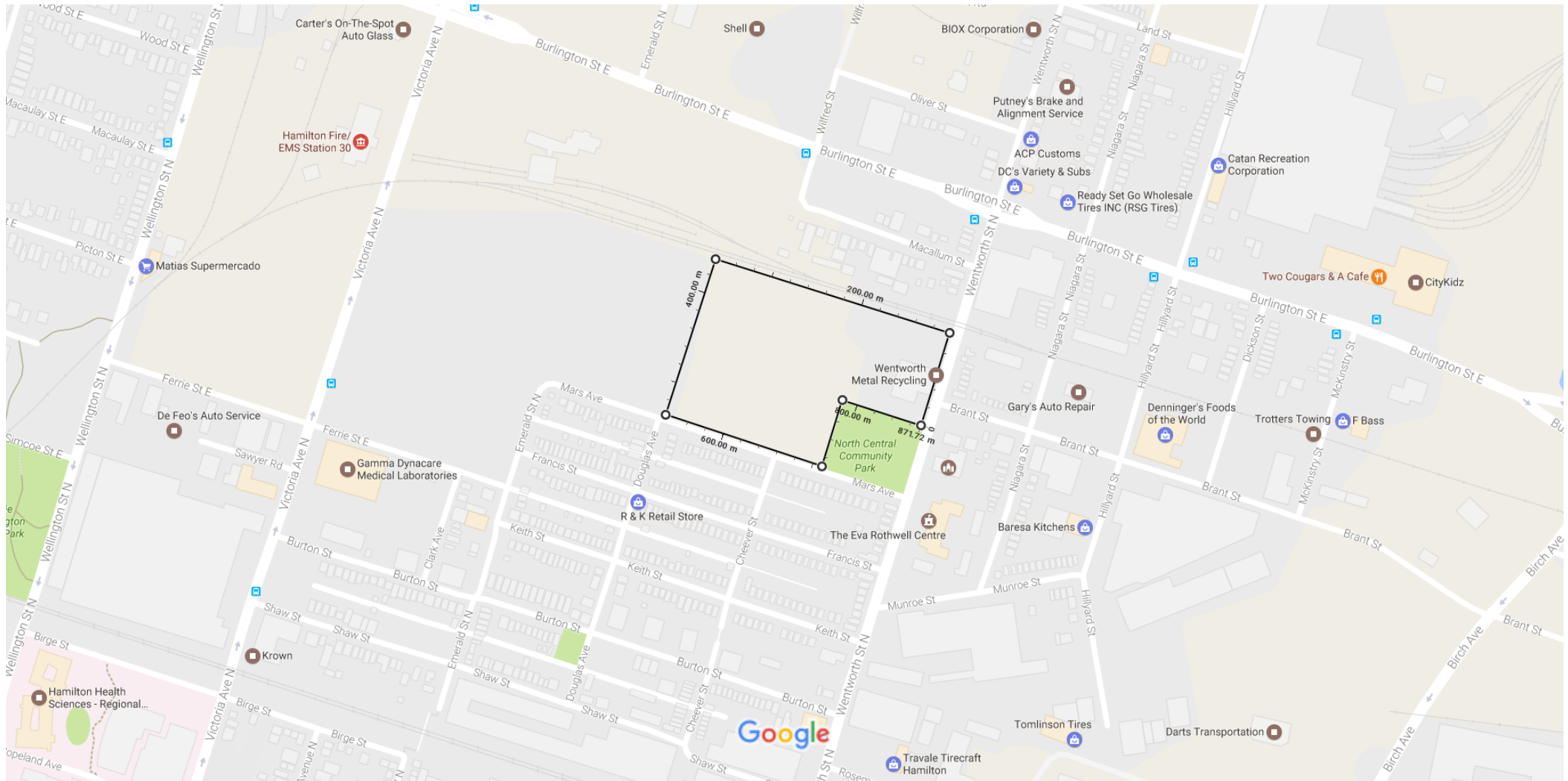

Map data ©2017 Google 100 m

Measure distance
Total area: 39,225.97 m² (422,224.82 ft²)
Total distance: 871.72 m (2,859.98 ft)

Google Maps Possible location for new Hess and Strathcona school

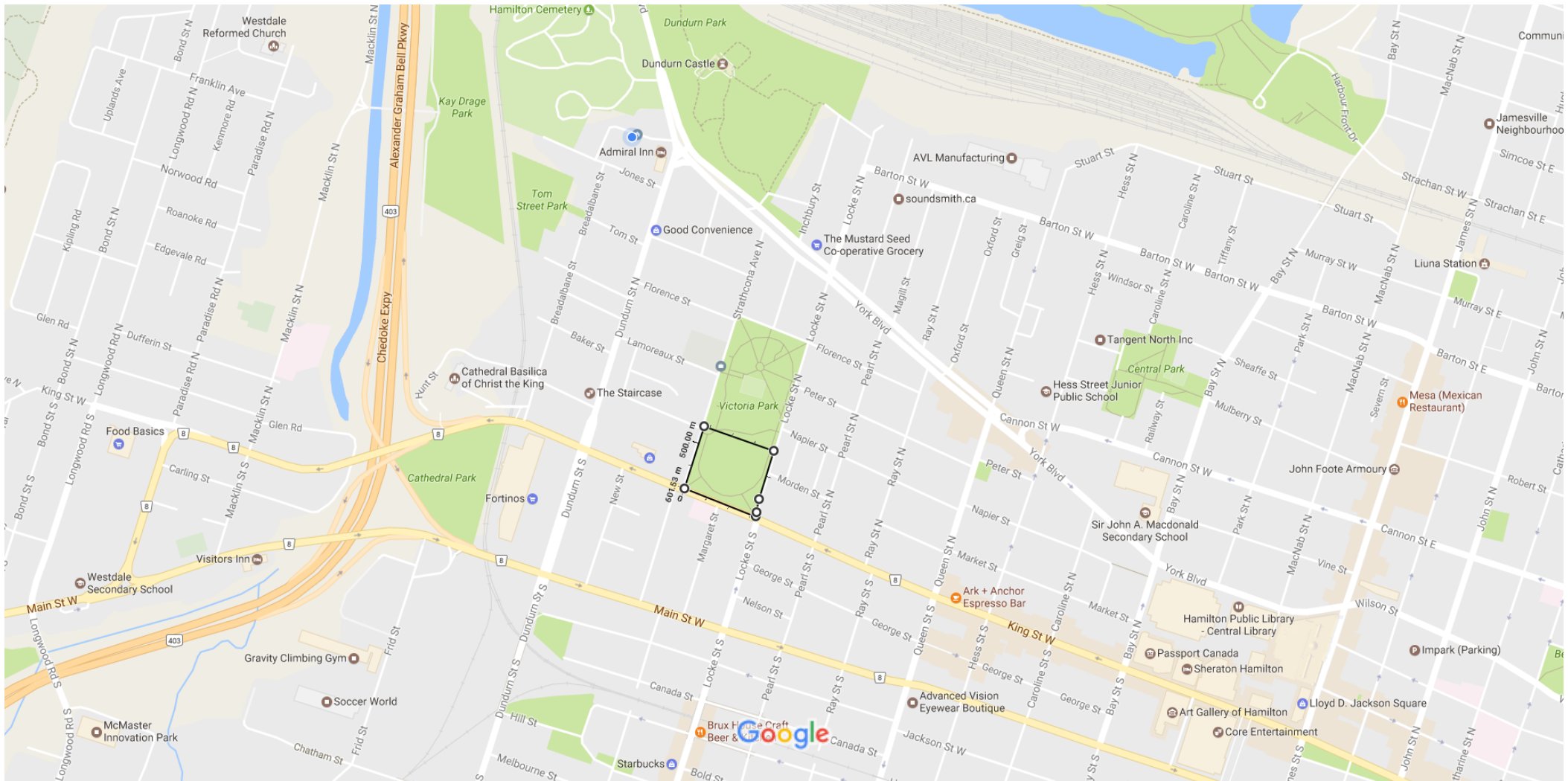

Measure distance
Total area: 22,253.39 m² (239,533.54 ft²)
Total distance: 601.53 m (1,973.53 ft)

Google Maps possible location for another school in the Kirkendall neighbourhood

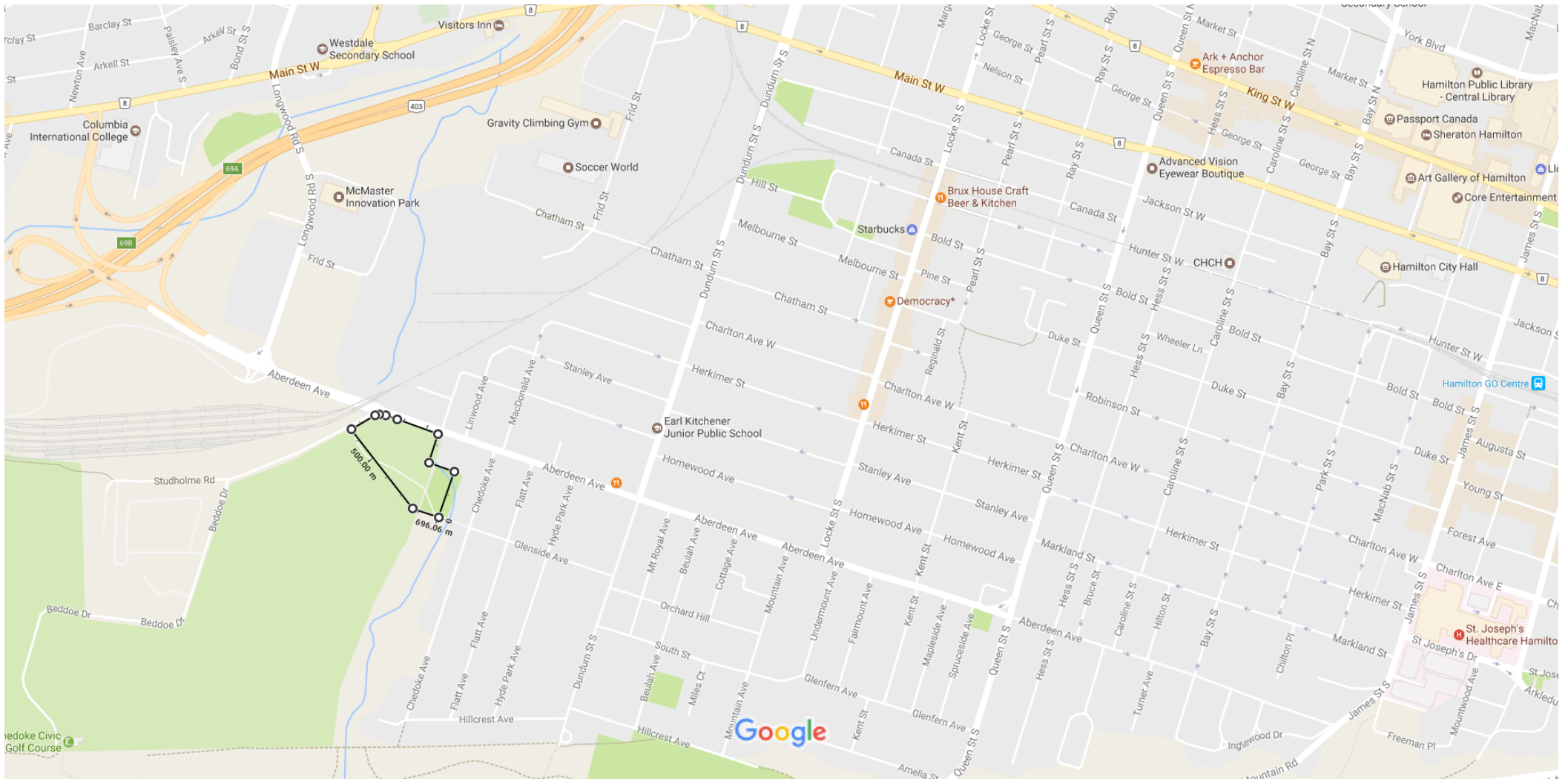

Measure distance
Total area: 24,500.52 m² (263,721.41 ft²)
Total distance: 696.06 m (2,283.67 ft)



March 20, 2017

TO: Superintendent Dunlop & members of the West Hamilton Accommodation Review committee, Hamilton-Wentworth District School Board

RE: Support for maintaining 9 HWDSB community schools

Dear Superintendent and members of the committee:

On behalf of the Beasley Neighbourhood Association, please accept this letter as a statement of support for options available to the Accommodation Review Committee that maintain the ongoing operation of the nine (9) existing public schools run by the HWDSB, namely: Central Elementary, Ryerson Middle, Earl Kitchener Elementary, Strathcona Elementary, Hess Street Elementary, Bennetto Elementary, Cathy Wever Elementary, Dr Edgar Davey Elementary & Queen Victoria Elementary.

In addition, we also explicitly oppose any option that does not maintain a Hess Street Elementary School (at its current or another nearby location) for the following reasons:

- (1) Hess Street Elementary serves a diverse student body that includes new Canadians and children from disadvantaged socioeconomic backgrounds;
- (2) The ability to safely walk to school in localized neighbourhoods (i.e. without crossing major roads) has positive impacts on both the health and well-being of schoolchildren;
- (3) The medium- and long-term effects of changing demographics in Hamilton's rapidly changing downtown does not appear to have been adequately assessed through your process, and;
- (4) Given the Beasley neighbourhood's improving experience with a Community Hub model at Dr. Davey Elementary, a model promoted by the Province and the Premier herself, we believe that depriving a community of a potential hub is a disservice to those residents.

We would be happy to discuss anything of these concerns further, and we wish you the best in making the a balanced and just decision for the lower city's families.

Sincerely,



Allison Chewter
President



Mike Borrelli
Treasurer