

Bellmoore & New School on Summit Park Site – Temporary Accommodation Strategy

Advisory Panel Meeting

January 15, 2019

Paul Denomme

Jeff Gillies

Ellen Warling

Ian Hopkins

Kathleen Hussey

Kevin Heer

Julie Anderson

Gord Cook

Alex Johnstone

Cam Galindo

Jackie Boyer

Richard Wouters

Scott Nguyen

Nicole Jones

Superintendent of Student Achievement

Superintendent of Student Achievement

Manager – Planning & Accommodation

Planner – Planning & Accommodation

Executive Assistant

Principal – Bellmoore

Principal – Janet Lee (New Summit Park School)

Principal – Tapleystown (New Summit Park School)

Board Chair, Trustee – Wards 11 & 12

Trustee – Wards 9 & 10

Bellmoore School Council Rep

Bellmoore School Council Rep

Tapleystown School Council Rep (Summit Park)

Janet Lee School Council Rep (Summit Park)

- Promote a positive environment
- Treat all other members and guests with respect
- Recognize and respect the personal integrity of each member of the advisory panel
- Use established communication channels when questions or concerns arise
- Promote high standards of ethical practice at all times

1. Trustee Resolution and Boundary Review Procedure
2. Timelines
3. Rationale for Transition
4. Summit Park Site Information
5. Binbrook & Bellmoore Information
6. Accommodation Strategy Review
7. Next Steps

- At the November 26, 2018, Board meeting, Trustees approved:
that Bellmore School be temporarily changed to a K-6 school until a permanent solution can be found to solve the accommodation pressures.
- The report states that the new school on the Summit Park site will be assisting with the accommodation pressures at Bellmore. Grades 7-8 students from Bellmore will be attending this new school until a permanent solution is provided for Binbrook.
- At the December 17, 2018, Board meeting, Trustees approved:
Be it resolved; that staff apply the boundary review policy to the temporary accommodation strategy at Bellmore Elementary (and to include other potential impacted schools) and report back to trustees no later than March 2019.

Purpose of a Boundary Review:

Hamilton-Wentworth District School Board (HWDSB) believes in optimizing and ensuring the effective and efficient use of all facilities to support student achievement.

Policy Outlines Steps to be undertaken by staff:

Create the boundary review advisory panel

Conduct a community consultation

Review the data from the community consultation

Present feedback to Board

The Boundary Review Advisory Panel may include the following members:

- Family of Schools Superintendent(s)
- Planning & Accommodation Staff
- Trustees of affected schools
- Principals of affected schools
- Up to two School Council Representatives from affected schools

Boundary Review Procedure 2.1

The mandate of the Boundary Review Advisory Panel is to advise the Superintendent of Student Achievement of possible options after reviewing the guiding principles, receiving community input and providing local expertise.

Boundary Review Policy 2.1

- Address the short and long-term accommodation requirements of the impacted communities in a timely manner;
- Be mindful of the best and most prudent use of all resources available to HWDSB
- Adhere to the guiding principles as defined in the Long- Term Facilities Master Plan including optimal school capacity, grade organization, transportation, facility requirements, site size and the balance between French Immersion and English track students in dual track schools
- Consult with the impacted school communities to gain further insight into the boundary recommendation(s).
- Where possible, attempt to create more socio-economically diverse school communities.
- Be mindful of the distance to the nearest school and the ability for students to safely travel to school.

Boundary Review Policy 2.1

The Advisory Panel will meet a minimum of once before and a minimum of once after the public meeting to review the following:

- a) Rationale for change
- b) Preferred option(s)
- c) Enrolment & facility utilization impacts
- d) Financial impacts
- e) Transportation impacts
- f) Community consultation
- g) Implementation considerations

Boundary Review Policy 2.1

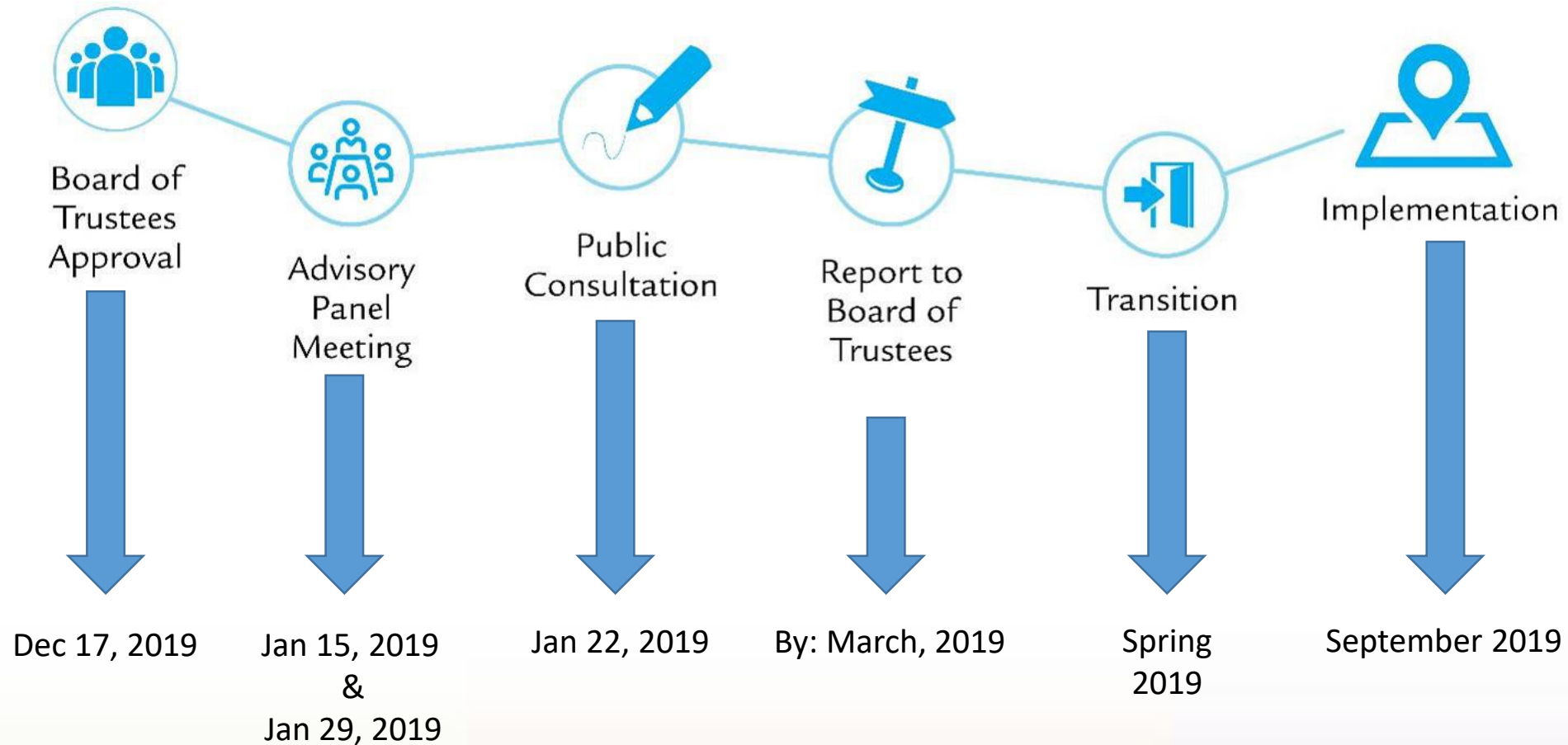

- Providing the best possible programming for students
- Address enrolment pressures at Bellmoore
- Without significant capital expenditures and extended timelines, Bellmoore cannot accommodate additional portables

- Improve student access to specialized spaces (Visual Art Room, Gym, Library and Music Room)
- Reduce enrolment at Bellmoore in 2019 to address accommodation pressure issues (parking, street traffic, student drop-off/pickup, access to washrooms)
- Create a more balanced and predictable enrolment between Bellmoore and the New School on the Summit Park Site
- Implement a strategy which is clear and concise for students, parents, staff and community

Bellmoore & New Summit Park School Current Enrolment and Boundaries

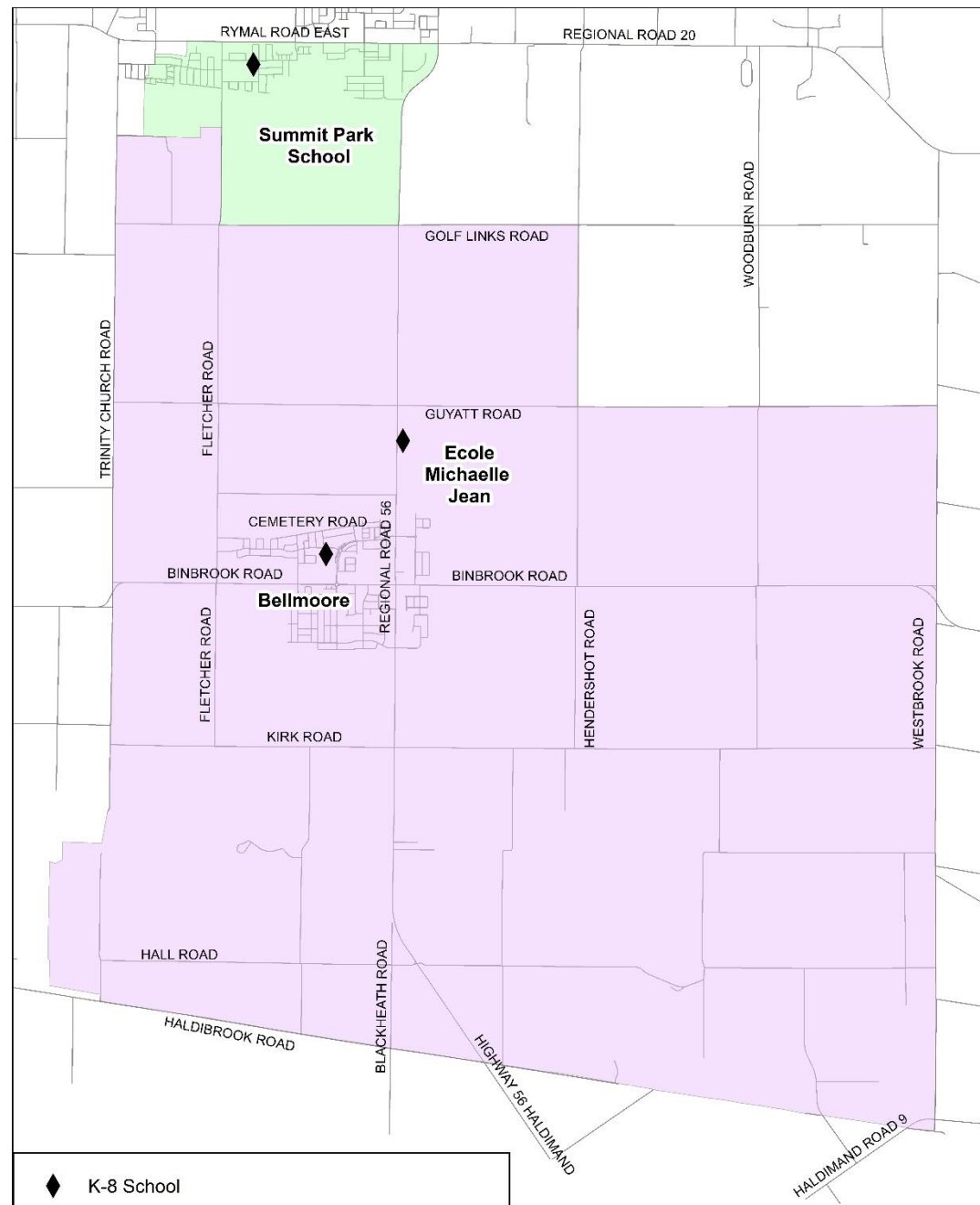

◆ K-8 School

Current Elem Boundary

■ Bellmoore

■ Summit Park

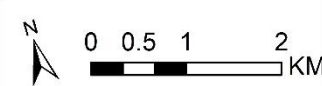

HWDSB
 January 2019
 Planning and Accommodation

Current Bellmoore and New School on the Summit Park Site Projections

	OTG	OTG with Portables
Bellmoore	640	1077 (19)
Summit Park Site	625	763 (6)

Bellmoore	JK	SK	1	2	3	4	5	6	7	8	SP-E	Total	Utilization	Utilization with Current Portables	Estimated Additional Portables Required (Total)
2018	131	144	115	114	108	104	107	104	99	89	6	1121	175%	106%	0
2019	133	146	120	123	120	110	117	115	106	101	6	1198	187%	111%	3 (22)
2020	135	148	121	127	128	121	123	124	116	108	6	1256	196%	117%	2 (24)
2021	136	149	122	122	128	130	123	124	125	118	6	1283	200%	119%	1 (25)
2022	139	139	124	125	125	131	132	125	127	128	6	1303	204%	121%	1 (26)
2023	141	141	115	126	126	127	133	134	127	128	6	1303	204%	121%	0 (26)

New School Summit Park Site	JK	SK	1	2	3	4	5	6	7	8	SP-E	Total	Utilization	Utilization with 6-room Portapak	Estimated Additional Portables Required (Total)
2019	56	53	50	33	43	43	35	36	37	42	0	426	68%	56%	0 (0)
2020	59	59	51	53	36	46	46	38	39	40	0	465	74%	61%	0 (0)
2021	61	61	56	53	55	38	48	48	40	41	0	497	80%	65%	0 (0)
2022	65	65	60	60	58	59	42	52	52	44	0	558	89%	73%	0 (0)
2023	70	70	64	65	65	63	64	47	57	57	0	620	99%	81%	0 (0)

- OTG: On-the-ground capacity - represents number of students the permanent structure of a school can accommodate based on Ministry of Education instructional space loading. Depending on programs and grade structure facilities can typically accommodate more students than its OTG

HWDSB

- Current owner of land is working with the City of Hamilton to complete the studies and reports required to move forward with developing the land.
- HWDSB will purchase land from owner at first available opportunity – projected 2021
- HWDSB will apply to the Ministry of Education at the first available opportunity for funding to construct the school
- If funding and land is acquired by end of 2021 the school could be constructed by 2023

Binbrook Identified School Site

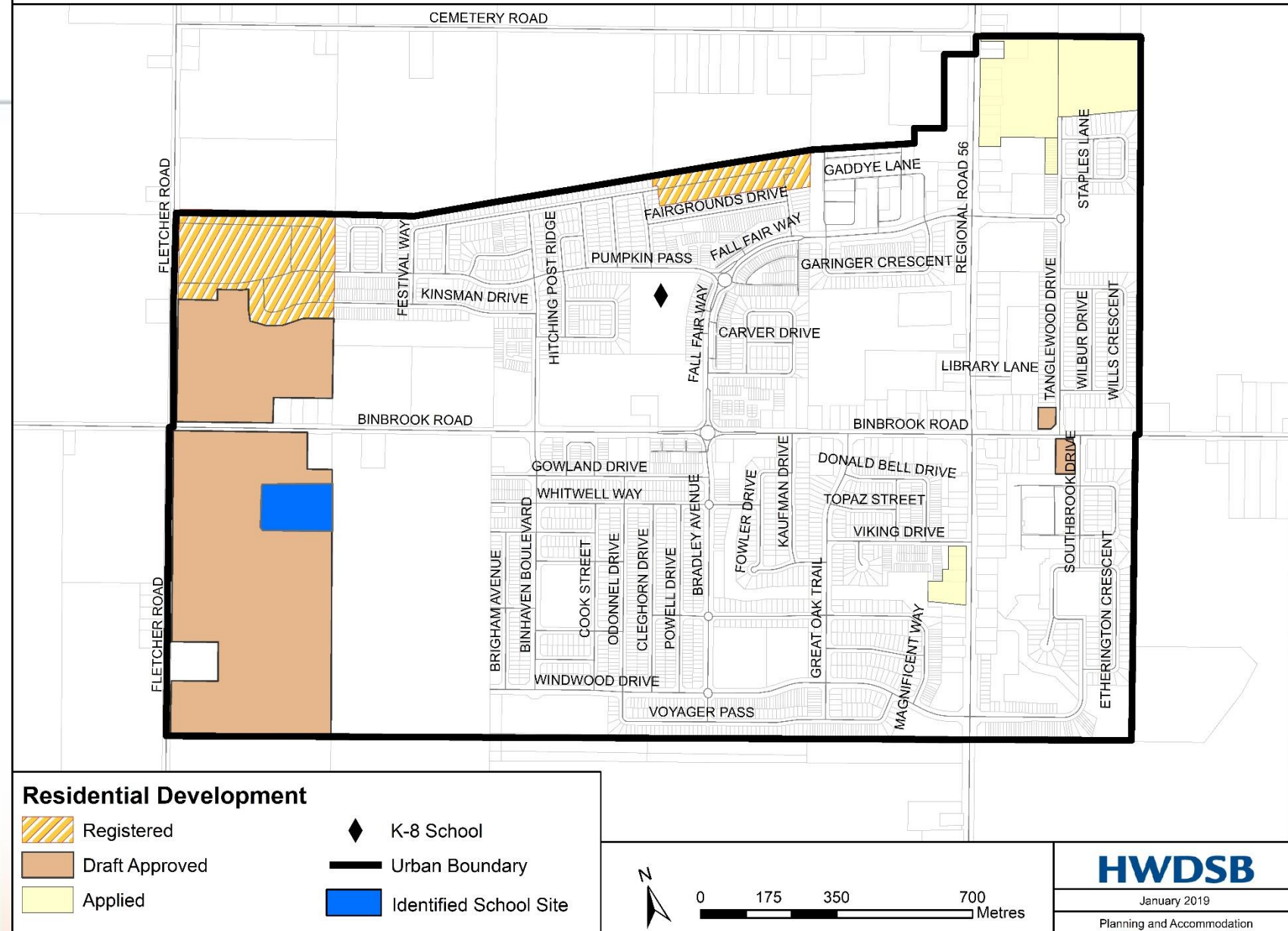

Summit Park School Information

Summit Park Timelines



HWDSB

New Summit Park School

- 625 pupil place K-8 school
- \$14,388,899 in funding
- 3-room Childcare centre
- 2-storey building
- Bus drop-off area
- 8+ acre site

Note: Image of proposed site plan and is subject to change

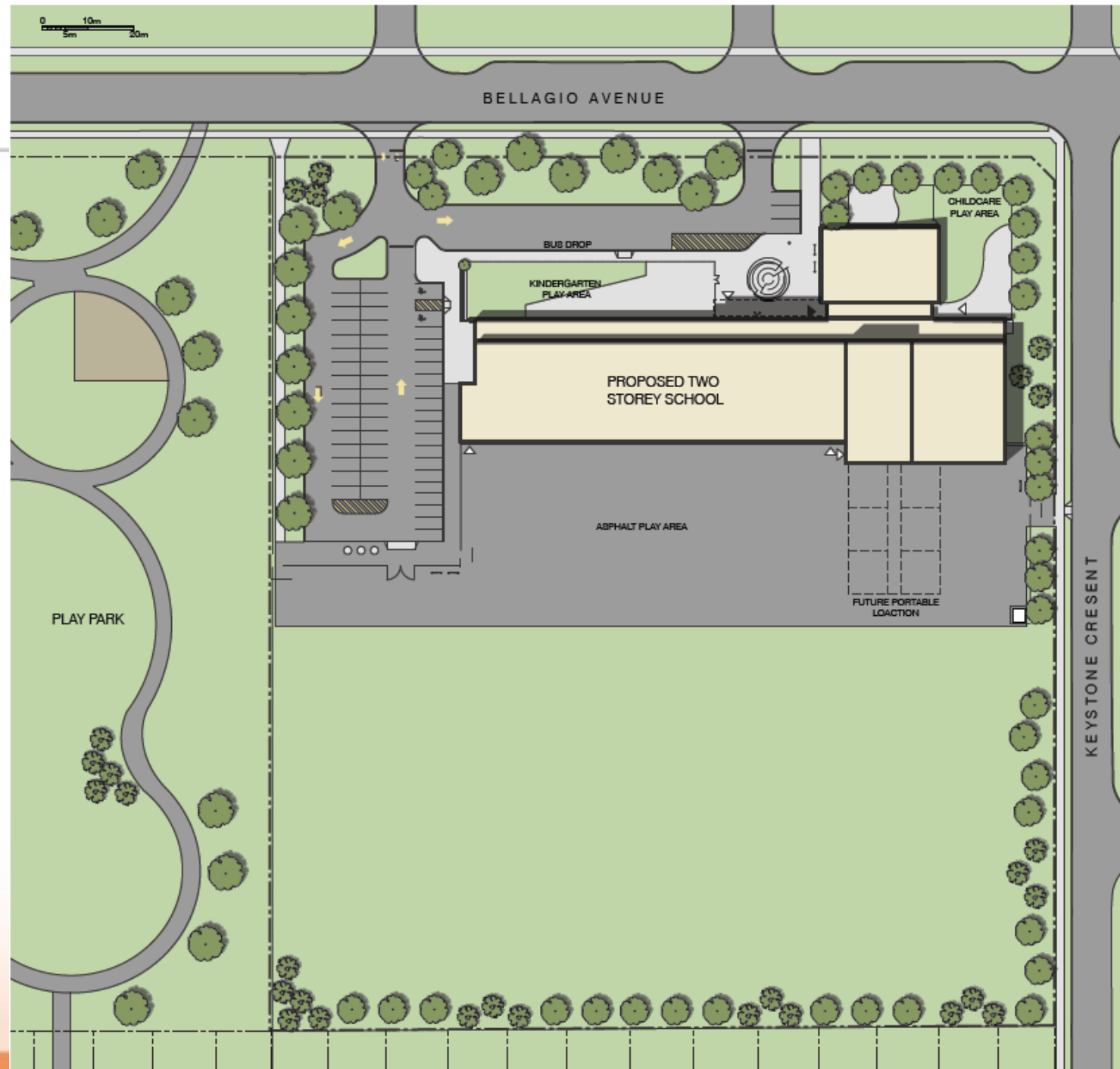

New Summit Park School

- 18 Classrooms
- 1 Special Education
- 5 Kindergarten
- Music Room
- Art Room
- Science Room
- Learning Commons
- Gym with Stage



Note: Plans and perspectives are artist rendering and final building may not be as shown)

Temporary Accommodation Strategies

New Capital - Options

Multiple storey or additional portables are possible but the municipal service requirements (electrical, washrooms, fire safety) for additional students are the barriers to adding portables. Construction timelines and funding are additional barriers to the proposed temporary solution for September 2019.

To add more portables at Bellmoore, we would need to address:

- Washroom counts (currently maxed out female washroom count)
- Parking space counts
- Portable access to fire hydrants (fire code)
- Setbacks from property line & berms on sides of property
- Bus pickup and drop off
- Childcare addition
- Sightlines/supervision due to portables
- Access to asphalt play area

- Currently, there are no funding opportunities available through the Ministry of Education for new capital.
- If funding were available to design and build an addition at Bellmoore could not be completed for September 2019.
- This option would still require a temporary accommodation solution prior to proposed addition being complete.

- Due to continued growth of the French Immersion enrolment, the facility does not have space to accommodate additional students
- Previously Michaelle Jean has been considered to be used to alleviate accommodation pressure at Bellmoore for a 1-year period
- Trustees approved that effective September 2012, a single track French Immersion program begin in grade 1 at the current Bellmoore School site on Highway 56 (renamed Ecole Michaelle Jean)

Capping Bellmoore's Enrolment - Options

Capping JK & No New SK-8 Students Enrol at Bellmoore

- The following scenario depicts capping the JK enrolment at 100 students per year and no new students would be enrolled at Bellmoore in grades SK-8.
- All projected JK students beyond 100 and new SK-8 students from housing development and housing sales attend New School on the Summit Park Site.

Capping JK & No New SK-8 Students Enrol at Bellmoore

	OTG	OTG with Portables
Bellmoore	640	1077 (19)
Summit Park Site	625	763 (6)

Bellmoore	JK	SK	1	2	3	4	5	6	7	8	SP-E	Total	Utilization	Utilization with Current Portables	Estimated Additional Portables Required (Total)
2018	131	144	115	114	108	104	107	104	99	89	6	1121	175%	106%	-
2019	100	123	110	109	106	100	99	100	97	95	6	1046	163%	97%	-3 (16)
2020	100	94	99	104	101	99	96	93	94	93	6	979	153%	91%	-2 (14)
2021	100	94	76	94	97	94	94	90	87	90	6	922	144%	86%	-2 (12)
2022	100	94	75	72	88	90	90	88	84	83	6	870	136%	81%	-2 (10)
2023	100	94	75	71	67	82	86	84	83	80	6	828	129%	77%	0 (10)

New School Summit Park Site	JK	SK	1	2	3	4	5	6	7	8	SP-E	Total	Utilization	Utilization with Current Portables	Estimated Additional Portables Required (Total)
2019	89	77	59	47	56	53	52	50	46	48	0	578	92%	76%	0 (6)
2020	93	113	73	75	62	68	72	69	61	54	0	741	119%	97%	0 (6)
2021	97	116	102	81	86	73	76	82	78	68	0	858	137%	112%	4 (10)
2022	104	111	109	114	95	100	84	89	95	89	0	991	159%	130%	5 (15)
2023	110	117	104	119	125	107	110	96	101	105	0	1096	175%	144%	4 (19)

Information to consider for this option:

- This scenario would allow JK students with and without siblings to enter Bellmoore but would require new families with students in grades SK-8 to attend Summit Park site. This could potentially separate new Binbrook families with students in JK and older grades
- This option would require an application and random selection process for JK entry at Bellmoore
- This option would also require the Board to clearly define what a “new student” means. New to Board? New to neighbourhood?

Information to consider for this option:

- Bellmoore enrolment and need for portables projected to decline
- Projected to require 10 portables at Bellmoore by 2023
- Enrolment at Summit Park site and need for portables projected to increase
- Projected to require 19 portables at Summit Park site by 2023

HWDSB Allowing Only Siblings to Attend Bellmoore

- The following scenario depicts only allowing students with siblings to enter JK Bellmoore starting in 2019.
- Based on the past three years of enrolment history at Bellmoore, on average approximately 39% of JK-3 students have an older sibling at Bellmoore.
- The 39% average has been applied to the incoming JK enrolment.
- All projected new students from housing development and housing resale attend New School on the Summit Park Site.

HWDSB Allowing Only Siblings to Attend Bellmoore

	OTG	OTG with Portables
Bellmoore	640	1077 (19)
Summit Park Site	625	763 (6)

Bellmoore	JK	SK	1	2	3	4	5	6	7	8	SP-E	Total	Utilization	Utilization with Current Portables	Estimated Additional Portables Required (Total)
2018	131	144	115	114	108	104	107	104	99	89	6	1121	175%	106%	0
2019	51	123	110	109	106	100	99	100	97	95	6	997	156%	93%	-5 (15)
2020	51	48	100	105	101	99	96	93	94	93	6	886	138%	82%	-4 (11)
2021	51	48	39	95	97	94	94	90	87	90	6	791	124%	73%	- 4 (7)
2022	51	48	39	37	88	91	90	88	84	83	6	705	110%	65%	-3 (4)
2023	51	48	39	37	34	82	87	84	83	80	6	631	99%	59%	-3 (1)

New School Summit Park Site	JK	SK	1	2	3	4	5	6	7	8	SP-E	Total	Utilization	Utilization with Current Portables	Estimated Additional Portables Required (Total)
2019	138	77	59	47	56	53	52	50	46	48	0	626	100%	82%	0 (6)
2020	142	159	72	75	62	68	72	69	61	54	0	835	134%	109%	3 (9)
2021	146	162	139	81	85	73	76	82	78	68	0	988	158%	130%	6 (15)
2022	153	156	145	148	95	100	84	89	95	89	0	1156	185%	151%	7 (22)
2023	159	163	140	154	157	107	110	96	101	105	0	1292	207%	169%	5 (27)

The 2019 to 2023 Bellmoore JK enrolment numbers are straight lined based on the 39% average sibling average. This assumes that the existing housing in Bellmoore will continue to yield approximately 130 JK students but only 39% of students will attend Bellmoore. Over time the percentage of students with an older sibling in Bellmoore may decrease, reducing Bellmoore's enrolment further and in turn increasing the new school on the Summit Park site more rapidly.

HWDSB Allowing Only Siblings to Attend Bellmoore

Information to consider for this option:

- Bellmoore enrolment and need for portables projected to decline
- Enrolment at Summit Park site and need for portables projected to increase
- Projected to require 27 portables at Summit Park site by 2023

Bellmore Grade Organization Change - Options

Bellmore Kindergarten Students Attend New School on the Summit Park Site

	OTG	OTG with Portables
Bellmore	640	1077 (19)
Summit Park Site	625	763 (6)

Bellmore	JK	SK	1	2	3	4	5	6	7	8	SP-E	Total	Utilization	Utilization with Current Portables	Estimated Additional Portables Required (Total)
2018	131	144	115	114	108	104	107	104	99	89	6	1121	175%	106%	0
2019	0	0	120	123	120	110	117	115	106	101	6	918	143%	85%	0 (19)
2020	0	0	121	127	128	121	123	124	116	108	6	973	152%	90%	0 (19)
2021	0	0	122	122	128	130	123	124	125	118	6	997	156%	93%	0 (19)
2022	0	0	124	125	125	131	132	125	127	128	6	1025	160%	95%	0 (19)
2023	0	0	115	126	126	127	133	134	127	128	6	1022	160%	95%	0 (19)

New School Summit Park Site	JK	SK	1	2	3	4	5	6	7	8	SP-E	Total	Utilization	Utilization with Current Portables	Estimated Additional Portables Required (Total)
2019	189	199	50	33	43	43	35	36	37	42	0	706	113%	92%	0 (6)
2020	193	207	51	53	36	46	46	38	39	40	0	748	120%	98%	0 (6)
2021	197	210	56	53	55	38	48	48	40	41	0	782	125%	103%	1 (7)
2022	204	204	60	60	58	59	42	52	52	44	0	836	134%	110%	2 (9)
2023	210	210	64	65	65	63	64	47	57	57	0	901	144%	118%	3 (12)

- Could be implemented through a two year process which phases in the grade change.
- 2019 only new JKs attend Summit Park site and in 2020 both JK & SK attend Summit Park Site

Information to consider for this option:

- 15-16 kindergarten classes at the Summit Park Site
- Youngest students on a bus from Binbrook to Summit Park site
- Projected to require 12 portables at Summit Park by 2023

Bellmoore Grade 7 & 8 Students Attend New School on the Summit Park Site

	OTG	OTG with Portables
Bellmoore	640	1077 (19)
Summit Park Site	625	763 (6)

Bellmoore	JK	SK	1	2	3	4	5	6	7	8	SP-E	Total	Utilization	Utilization with Current Portables	Estimated Additional Portables Required (Total)
2018	131	144	115	114	108	104	107	104	99	89	6	1121	175%	106%	-
2019	133	146	120	123	120	110	117	115	0	0	6	990	155%	92%	0 (19)
2020	135	148	121	127	128	121	123	124	0	0	6	1032	161%	96%	0 (19)
2021	136	149	122	122	128	130	123	124	0	0	6	1040	162%	97%	0 (19)
2022	139	139	124	125	125	131	132	125	0	0	6	1048	164%	97%	0 (19)
2023	141	141	115	126	126	127	133	134	0	0	6	1048	164%	97%	0 (19)

New School Summit Park Site	JK	SK	1	2	3	4	5	6	7	8	SP-E	Total	Utilization	Utilization with Current Portables	Estimated Additional Portables Required (Total)
2019	56	53	50	33	43	43	35	36	143	143	0	634	101%	83%	0 (6)
2020	59	59	51	53	36	46	46	38	155	147	0	689	110%	90%	0 (6)
2021	61	61	56	53	55	38	48	48	165	158	0	740	118%	97%	0 (6)
2022	65	65	60	60	58	59	42	52	179	172	0	813	130%	107%	2 (8)
2023	70	70	64	65	65	63	64	47	184	185	0	876	140%	115%	3 (11)

- Could be implemented through a two year process which phases in the grade change
- 2019 only grade 7s attend Summit Park site while grade 8s remain at Bellmoore to graduate
- 2020, grade 7 & 8s attend Summit Park Site

Information to consider for this option:

- Large middle school enrolment can be easier to accommodate than K or primary students
- Oldest elementary students on a bus from Binbrook to Summit Park site
- Projected to require 11 portables at Summit Park by 2023

Bellmore Boundary Changes - Options

North & East Portion of Bellmoore Catchment and New Development attend New School on the Summit Park Site

	OTG	OTG with Portables
Bellmoore	640	1077 (19)
Summit Park Site	625	763 (6)

Bellmoore	JK	SK	1	2	3	4	5	6	7	8	SP-E	Total	Util	Util with Current Portables	Estimated Additional Portables Required (Total)
2018	131	144	115	114	108	104	107	104	99	89	6	1121	175%	106%	-
2019	111	126	97	105	96	89	93	89	81	82	6	975	152%	91%	0 (19)
2020	111	122	102	102	108	96	98	98	89	81	6	1012	158%	94%	0 (19)
2021	111	122	98	102	102	108	96	98	98	89	6	1029	161%	96%	0 (19)
2022	111	111	98	99	102	102	108	96	98	98	6	1031	161%	96%	0 (19)
2023	112	112	89	98	99	103	102	109	96	98	6	1025	160%	95%	0 (19)

New School Summit Park Site	JK	SK	1	2	3	4	5	6	7	8	SP-E	Total	Util	Util with Current Portables	Estimated Additional Portables Required (Total)
2019	78	73	72	51	67	64	58	61	62	61	0	648	104%	85%	0 (6)
2020	83	85	70	78	56	71	71	64	66	67	0	709	113%	93%	0 (6)
2021	86	88	80	73	81	59	74	74	67	69	0	750	120%	98%	0 (6)
2022	93	93	86	87	80	88	66	82	81	74	0	830	133%	109%	3 (9)
2023	99	99	90	92	93	86	94	72	87	87	0	898	144%	118%	3 (12)

Approximately 210 Bellmoore students move to Summit Park

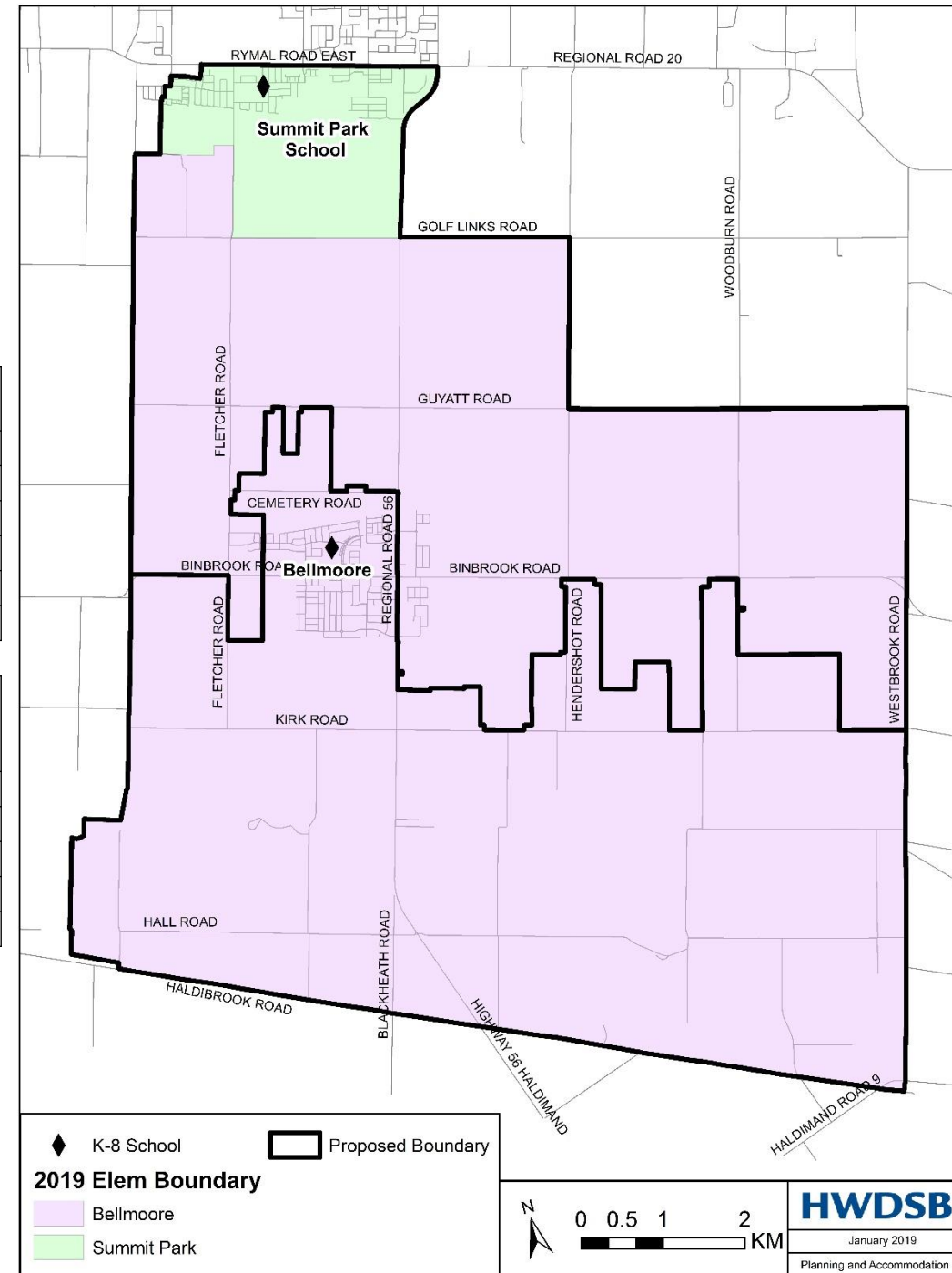

Information to consider for this option:

- Bellmoore projected to not require additional portables
- Long-term enrolment at Bellmoore projected to stabilize
- Summit Park site projected to require 12 portables by 2023

Rural Portion of Bellmoore Catchment and West Portion of New Development Attend New School on the Summit Park Site

	OTG	OTG with Portables
Bellmoore	640	1077 (19)
Summit Park Site	625	763 (6)

Bellmoore	JK	SK	1	2	3	4	5	6	7	8	SP-E	Total	Util	Util with Current Portables	Estimated Additional Portables Required (Total)
2018	131	144	115	114	108	104	107	104	99	89	6	1121	175%	106%	-
2019	120	134	110	108	105	98	105	102	91	82	6	1061	166%	98%	0 (19)
2020	120	132	109	115	111	105	108	111	102	91	6	1109	173%	103%	0 (19)
2021	120	132	107	109	115	111	105	108	111	102	6	1124	176%	104%	0 (19)
2022	121	121	108	108	110	117	113	107	109	112	6	1132	177%	105%	0 (19)
2023	123	123	99	109	110	112	118	114	108	111	6	1133	177%	105%	0 (19)

New School Summit Park Site	JK	SK	1	2	3	4	5	6	7	8	SP-E	Total	Util	Util with Current Portables	Estimated Additional Portables Required (Total)
2019	69	65	60	48	58	55	46	49	52	61	0	563	90%	74%	0 (6)
2020	74	75	64	64	53	62	61	51	53	57	0	612	98%	80%	0 (6)
2021	77	78	71	67	68	56	65	64	54	56	0	655	105%	86%	0 (6)
2022	83	83	77	77	73	74	62	71	70	60	0	729	117%	96%	0 (6)
2023	87	87	80	81	82	78	78	66	76	74	0	791	126%	104%	1 (7)

Approximately 122 existing Bellmoore students move to Summit Park

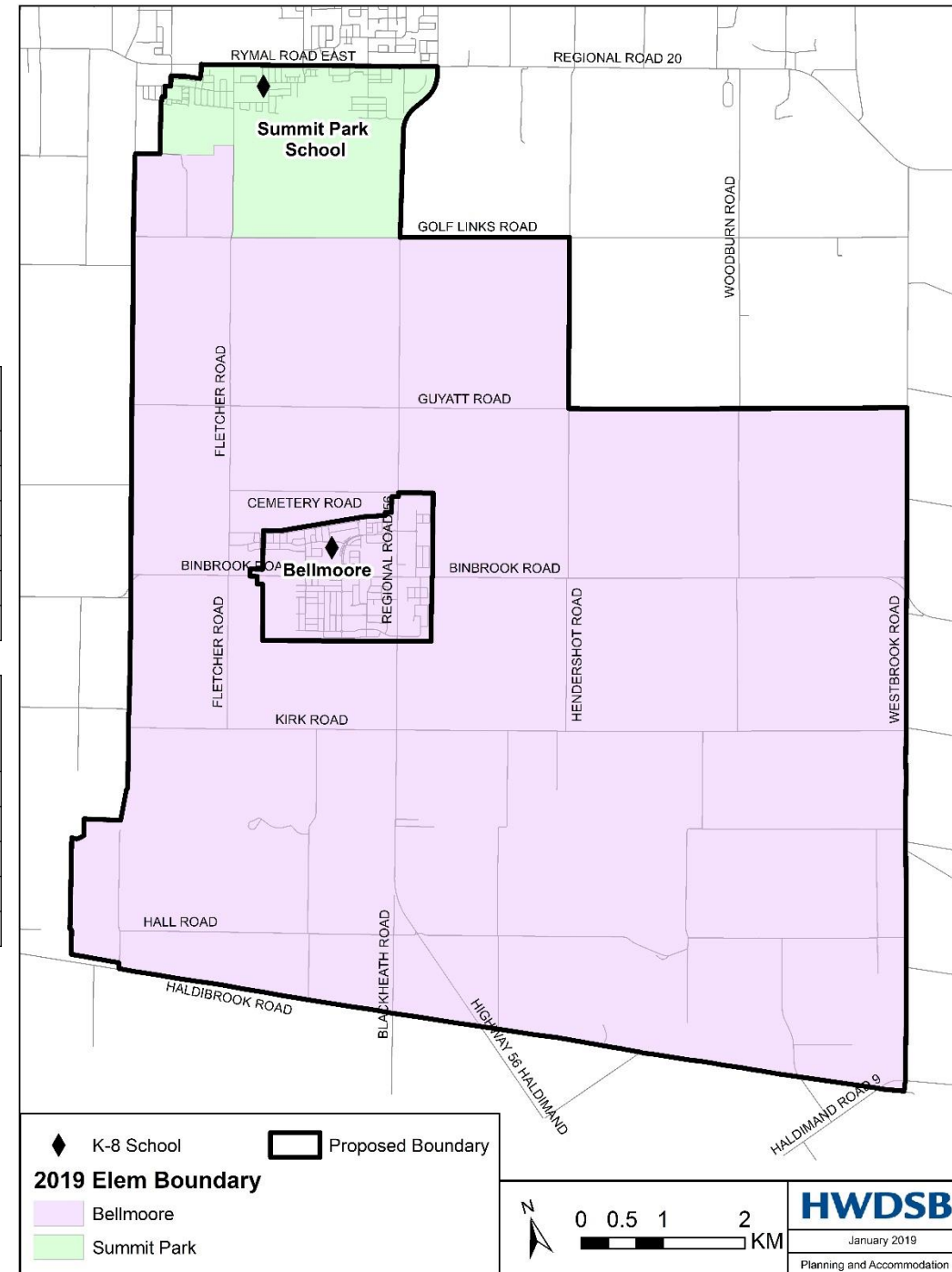

Information to consider for this option:

- Bellmoore projected to not require additional portables
- Long-term enrolment at Bellmoore projected to stabilize at approximately 1,130
- Summit Park site projected to require 7 portables by 2023

South West & North Portion of Bellmoore Catchment and Fletcher Road New Development Attend New School on the Summit Park Site

	OTG	OTG with Portables
Bellmoore	640	1077 (19)
Summit Park Site	625	763 (6)

Bellmoore	JK	SK	1	2	3	4	5	6	7	8	SP-E	Total	Util	Util with Current Portables	Estimated Additional Portables Required (Total)
2018	131	144	115	114	108	104	107	104	99	89	6	1121	175%	106%	-
2019	101	115	83	94	84	87	90	82	87	85	6	915	143%	85%	0 (19)
2020	103	113	94	88	98	85	97	96	84	89	6	952	149%	88%	0 (19)
2021	104	114	92	95	90	99	87	99	98	85	6	968	151%	90%	0 (19)
2022	107	107	95	95	98	93	102	89	102	100	6	994	155%	92%	0 (19)
2023	109	109	88	96	96	99	94	104	91	103	6	995	155%	92%	0 (19)

New School Summit Park Site	JK	SK	1	2	3	4	5	6	7	8	SP-E	Total	Util	Util with Current Portables	Estimated Additional Portables Required (Total)
2019	88	85	86	62	79	66	61	68	56	58	0	709	113%	93%	0 (6)
2020	91	94	79	91	66	82	71	65	71	59	0	769	123%	101%	0 (6)
2021	93	96	86	80	93	68	84	73	67	73	0	812	130%	106%	2 (8)
2022	97	97	90	90	85	98	72	88	77	72	0	867	139%	114%	2 (10)
2023	102	102	91	95	95	90	102	77	93	82	0	928	149%	122%	3 (13)

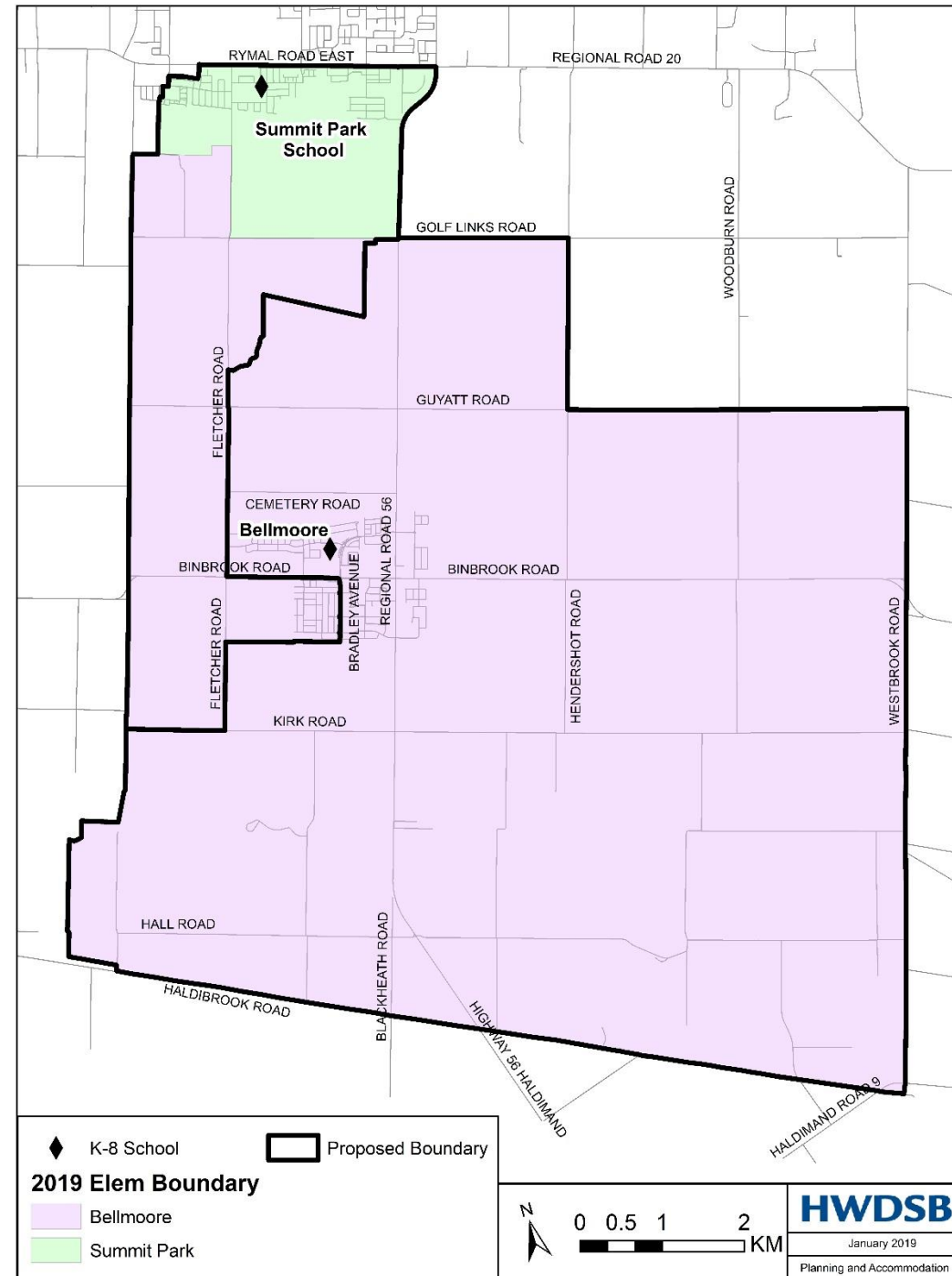

◆ K-8 School ▭ Proposed Boundary
2019 Elem Boundary
■ Bellmoore
■ Summit Park

N 0 0.5 1 2 KM
HWDSB
 January 2019
 Planning and Accommodation

Approximately 269 Bellmoore students move to Summit Park

Information to consider for this option:

- Bellmoore projected to not require additional portables
- Long-term enrolment at Bellmoore projected to stabilize under 1,000
- Portables could potentially be removed from Bellmoore
- Summit Park site projected to require approximately 13 portables by 2023

East of Highway 56 Attend New School on the Summit Park Site

	OTG	OTG with Portables
Bellmoore	640	1077 (19)
Summit Park Site	625	763 (6)

Bellmoore	JK	SK	1	2	3	4	5	6	7	8	SP-E	Total	Util	Util with Current Portables	Estimated Additional Portables Required (Total)
2018	131	144	115	114	108	104	107	104	99	89	6	1121	175%	106%	-
2019	113	126	100	104	100	89	93	89	79	80	6	980	153%	91%	0 (19)
2020	115	126	103	106	109	102	99	98	91	81	6	1036	162%	96%	0 (19)
2021	116	127	103	104	108	110	103	101	100	92	6	1071	167%	99%	0 (19)
2022	118	118	105	105	106	110	112	105	103	102	6	1088	170%	101%	0 (19)
2023	118	118	96	105	105	107	110	112	105	103	6	1085	170%	101%	0 (19)

New School Summit Park Site	JK	SK	1	2	3	4	5	6	7	8	SP-E	Total	Util	Util with Current Portables	Estimated Additional Portables Required (Total)
2019	76	74	69	52	62	64	59	61	64	63	0	643	103%	84%	0 (6)
2020	79	81	69	73	55	65	69	63	64	67	0	685	110%	90%	0 (6)
2021	81	83	74	71	75	57	67	71	65	66	0	709	113%	93%	0 (6)
2022	86	86	80	80	77	81	63	73	76	71	0	772	124%	101%	0 (6)
2023	92	92	84	86	86	83	87	69	79	82	0	838	134%	110%	3 (9)

Approximately 223 Bellmoore students move to Summit Park

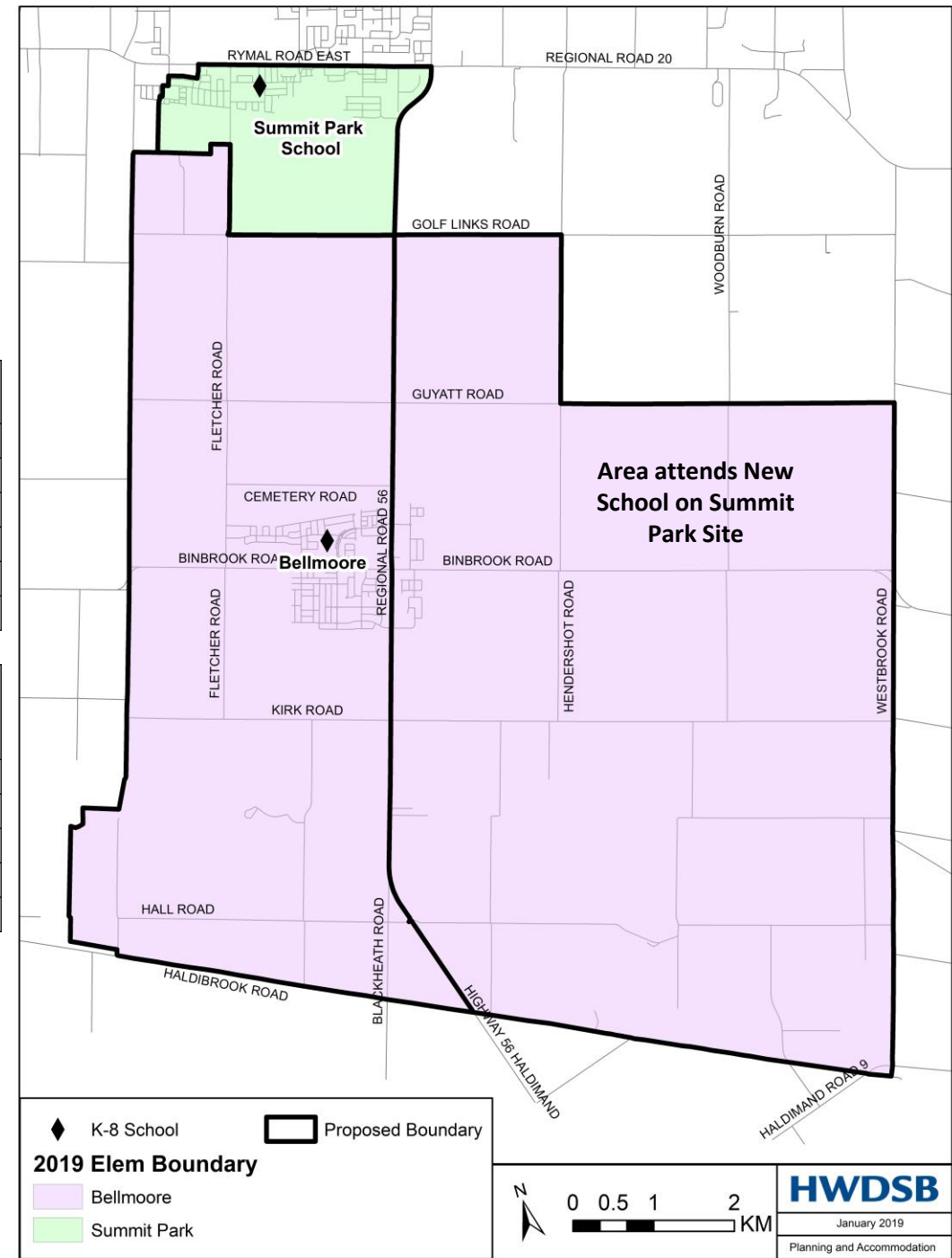

Information to consider for this option:

- Bellmoore projected to not require additional portables
- Long-term enrolment at Bellmoore projected to stabilize under 1,100
- Summit Park site projected to require approximately 9 portables by 2023

- Advisory Panel to review each option and discuss the pro/cons and feasibility
- Which options have we not considered that the Advisory Panel would like staff to review?
- Narrow down which options are best to seek public feedback on

Format:

- Presentation from staff
- Opportunity for facilitated feedback on the options
- Prior to the end of the meeting, a facilitator will share with the group a summary of feedback heard

Date	Event	Location
Tuesday Jan 22, 2019	Community Consultation (Public Meeting)	Bellmoore – 6 pm
Tuesday Jan 29, 2019	Advisory Panel Follow-up meeting	Bellmoore – 6 pm

Boundary review will follow HWDSB's Boundary Review [Policy](#) and [Procedure](#).

khussey@hwdsb.on.ca

All information presented will be posted on the Board website:

<http://www.hwdsb.on.ca/bellmoore/temporary-accommodation/>

THANK YOU